

# A57 Link Roads TR010034

## 2.7 Engineering Drawings and Sections Plans

APFP Regulation 5(2)(o), 6(2)(a) and 6(2)(b)

Planning Act 2008 Infrastructure Planning (Applications: Prescribed  
Forms and Procedure) Regulations 2009



# Infrastructure Planning

## Planning Act 2008

### The Infrastructure Planning (Applications: Prescribed Forms and Procedure) Regulations 2009

#### A57 Link Roads Scheme

#### Development Consent Order 202[x]

---

### 2.7 ENGINEERING DRAWINGS AND SECTIONS PLANS

---

<b>Regulation Number:</b>	Regulation 5(2)(o), Regulation 6(2)(a) and 6(2)(b)
<b>Planning Inspectorate Scheme Reference</b>	TR010034
<b>Application Document Reference</b>	TR010034/APP/2.7
<b>Author:</b>	A57 Link Roads Scheme Project Team, Highways England

<b>Version</b>	<b>Date</b>	<b>Status of Version</b>
Rev 1.0	June 2021	DCO Application

# Table of contents

<b>Chapter</b>	<b>Pages</b>
<b>1. Introduction</b>	<b>4</b>
1.1 Introduction and purpose of this document	4
<b>2. Schedule of plans included in this application document</b>	<b>5</b>

# 1. Introduction

## 1.1 Introduction and purpose of this document

1.1.1 Highways England (the “Applicant”) has applied to the Secretary of State for Development Consent Order (“DCO”) to determine the Applicant’s proposals for the creation of new link roads and alteration to the existing A57, A57 Link Roads (the “Scheme”). The application is submitted to the Planning Inspectorate (the “Inspectorate”) in accordance with section 37 of the Planning Act 2008 (the “2008 Act”).

1.1.2 This document comprises part of the suite of Application documents and is submitted to comply with Regulation 5(2)(o), 5(2)(p) and 6(2) of the Infrastructure Planning (Applications: Prescribed Forms and Procedure) Regulations 2009 (as amended), which requires:

*5(2)(o) ‘any other plans, drawings and sections necessary to describe the proposals for which development consent is sought, showing details of design, external appearance, and the preferred layout of buildings and structures, drainage, surface water management, means of vehicular and pedestrian access, any car parking to be provided, and means of landscaping;’*

*6(2) ‘If the application is for highway related development or for the construction or alteration of a railway, it must be accompanied by section drawings to suitable horizontal and vertical scales, which show, by reference to Ordnance Survey or Chart datum*

*(a) the levels of the proposed works, including in particular and where relevant:*

*(i) ground levels;*

*(ii) the height of every proposed bridge, viaduct, aqueduct, embankment and elevated guideway;*

*(iii) the depth of every proposed cutting and tunnel;*

*(iv) the levels of the bed of any tidal waters or inland waterway in which it is proposed that any works should be situated;*

*(v) the height of every structure or device (including a cable, but not catenary and related equipment) intended to be erected above, on or below the surface of, or on or beneath the bed of tidal waters or an inland waterway; and*

*(vi) drainage outfall details for highways.*

*(b) a cross section of every intended tunnel and any altered gradient of a carriageway or a way forming part of a guided transport system on either side of every level crossing, bridge, tunnel or underpass which would carry the carriageway or way or through which it would pass.’*

1.1.3 This document should be read alongside and is informed by the other Application documents, in particular:

- Schedule 1 to the Draft Development Consent Order [TR010034/APP/3.1]
- Works Plans [TR010034/APP/2.3]
- Scheme Layout Plans [TR010034/APP/2.6]

## 2. Schedule of plans included in this application document

Document title	Document number	Version
2.7 Engineering Drawings and Sections – Key Plan Regulation 5(4)	TR010034/APP/2.7 HE551473-BBA-LDC- A57_AL_SCHEME-DR-ZL-020720	P01
2.7 Engineering Drawings and Sections – Cross Section Regulation 5(2)(o) and 6(2). Sheet 1 of 3	TR010034/APP/2.7 HE551473-BBA-LDC- A57_AL_SCHEME-DR-ZL-020721	P01
2.7 Engineering Drawings and Sections – Cross Section Regulation 5(2)(o) and 6(2). Sheet 2 of 3	TR010034/APP/2.7 HE551473-BBA-LDC- A57_AL_SCHEME-DR-ZL-020722	P01
2.7 Engineering Drawings and Sections – Cross Section Regulation 5(2)(o) and 6(2). Sheet 3 of 3	TR010034/APP/2.7 HE551473-BBA-LDC- A57_AL_SCHEME-DR-ZL-020723	P01
2.7 Engineering Drawings and Sections – Structure Details Old Mill Farm Underpass Regulation 5(2)(o) and 6(2). Sheet 1 of 5	TR010034/APP/2.7 HE551473-BBA-LDC- A57_AL_SCHEME-DR-ZL-020731	P01
2.7 Engineering Drawings and Sections – Structure Details Roe Cross Road Underpass Regulation 5(2)(o) and 6(2). Sheet 2 of 5	TR010034/APP/2.7 HE551473-BBA-LDC- A57_AL_SCHEME-DR-ZL-020732	P01
2.7 Engineering Drawings and Sections – Structure Details Mottram Underpass Regulation 5(2)(o) and 6(2). Sheet 3 of 5	TR010034/APP/2.7 HE551473-BBA-LDC- A57_AL_SCHEME-DR-ZL-020733	P01
2.7 Engineering Drawings and Sections – Structure Details Mottram Underpass Regulation 5(2)(o) and 6(2). Sheet 4 of 5	TR010034/APP/2.7 HE551473-BBA-LDC- A57_AL_SCHEME-DR-ZL-020734	P01
2.7 Engineering Drawings and Sections – Structure Details River Etherow Bridge Regulation 5(2)(o) and 6(2). Sheet 5 of 5	TR010034/APP/2.7 HE551473-BBA-LDC- A57_AL_SCHEME-DR-ZL-020734	P01

DO NOT SCALE

100  
Millimetres  
0 10

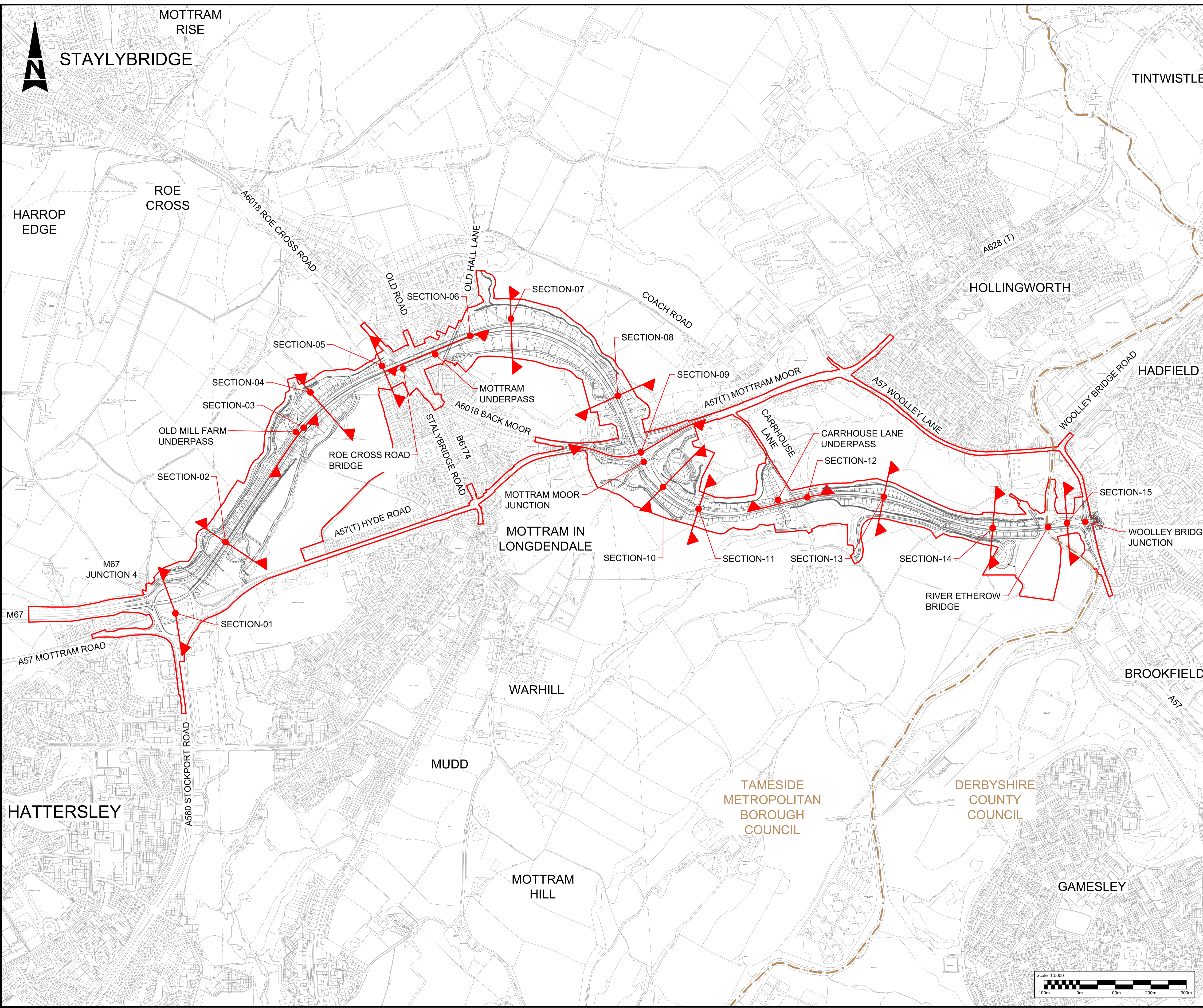

- NOTES**
- FOR SECTIONS SEE DRAWINGS NUMBERS:  
HE551473-BBA-LDC-A57\_AL\_SCHEME-DR-ZL-020721  
HE551473-BBA-LDC-A57\_AL\_SCHEME-DR-ZL-020722  
HE551473-BBA-LDC-A57\_AL\_SCHEME-DR-ZL-020723
  - FOR STRUCTURE DETAILS SEE DRAWINGS NUMBERS:  
HE551473-BBA-LDC-A57\_AL\_SCHEME-DR-ZL-020731  
HE551473-BBA-LDC-A57\_AL\_SCHEME-DR-ZL-020732  
HE551473-BBA-LDC-A57\_AL\_SCHEME-DR-ZL-020733  
HE551473-BBA-LDC-A57\_AL\_SCHEME-DR-ZL-020734  
HE551473-BBA-LDC-A57\_AL\_SCHEME-DR-ZL-020735
  - THE PROPOSED WORKS WILL BE SUBJECT TO DETAILED DESIGN DEVELOPMENT. ANY CHANGES WILL BE LIMITED TO BEING WITHIN THE DCO BOUNDARY OR THE RELEVANT LIMITS OF DEVIATION, AND SUBJECT TO THE REQUIREMENTS OF SCHEDULE 2 OF THE DEVELOPMENT CONSENT ORDER (TR010034/APP/3.1).

- LEGEND**
- SECTION MARKER AND ORIENTATION
  - DEVELOPMENT CONSENT ORDER (DCO) BOUNDARY
  - LOCAL AUTHORITY BOUNDARY

This map is based on Ordnance Survey material with the permission of Ordnance Survey on behalf of the Controller of Her Majesty's Stationary Office. © Crown copyright. Unauthorised reproduction infringes Crown copyright and may lead to prosecution or civil proceedings. Highways England 100030640\_2021

Description	Status	Revision	Issue Date
DCO APPLICATION	A4	P01	14/05/21
Drawing Suitability	DCO APPLICATION		Status A4

Client			
Scheme Name	A57 LINK ROADS		
Drawing Title	CROSS SECTIONS KEY PLAN REGULATION 5(4) SHEET 1 OF 1		
PINS Ref No:	TR010034/APP/2.7		
Drawing Number	HE551473	Originator	BBA LDC
Location	A57_AL_SCHEME	Type	DR · ZL · 020720
Scale:	1:5000 @ A1	Original Size:	A1
Rev:	P01		

Millimetres  
0 10  
**DO NOT SCALE**

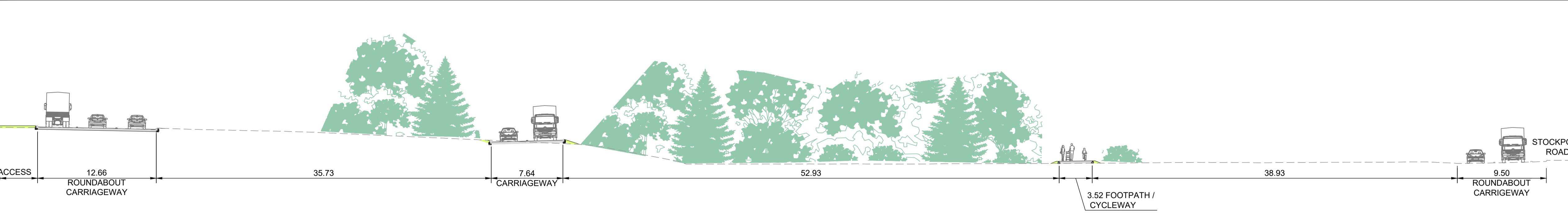

**SECTION-01 : A57 LINK ROADS**  
SCALE 1:250

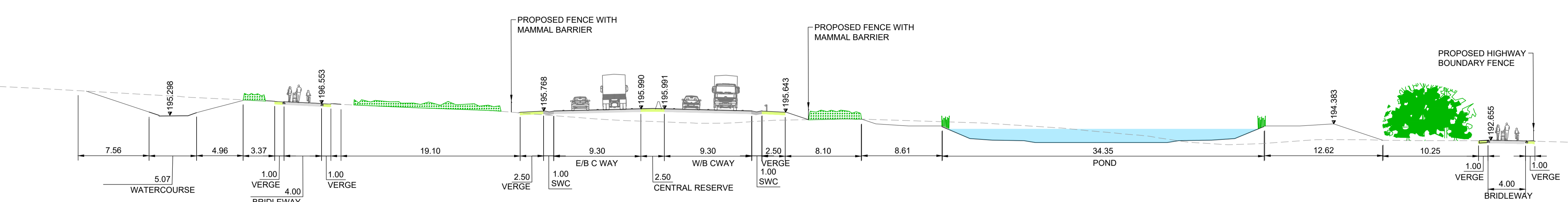

**SECTION-02 : A57 LINK ROADS**  
SCALE 1:250

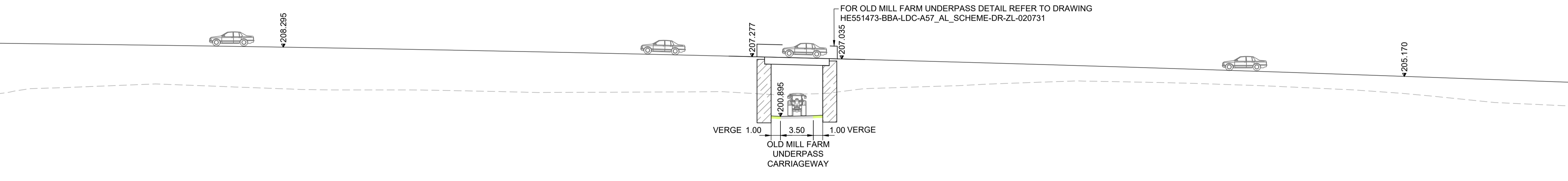

**SECTION-03 : A57 LINK ROADS**  
SCALE 1:250

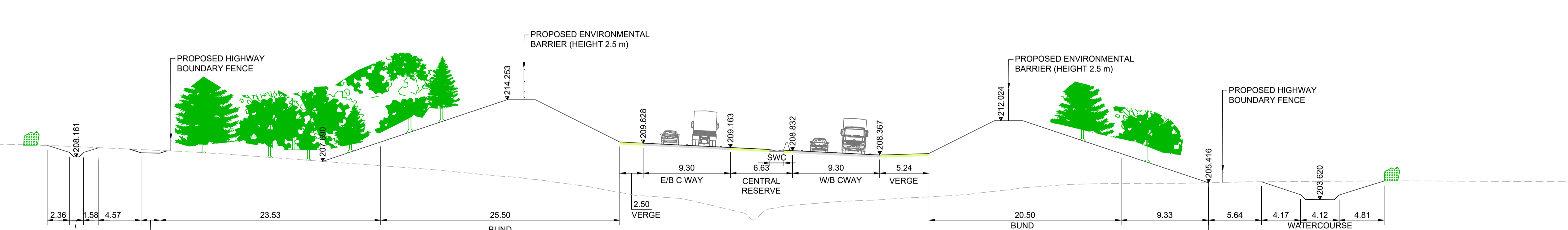

**SECTION-04 : A57 LINK ROADS**  
SCALE 1:250

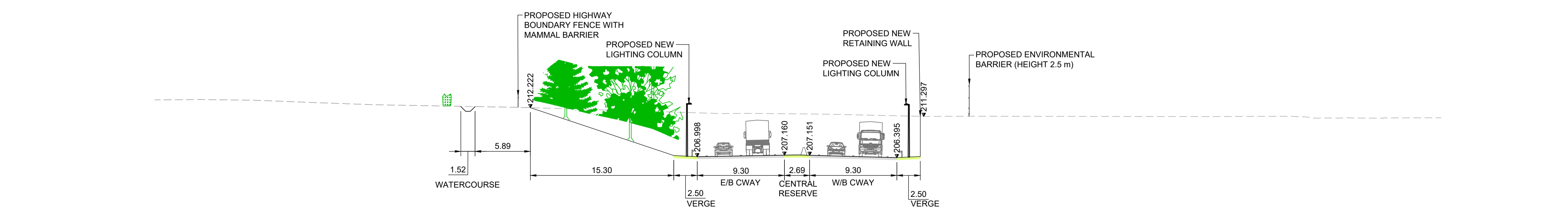

**SECTION-05 : A57 LINK ROADS**  
SCALE 1:250

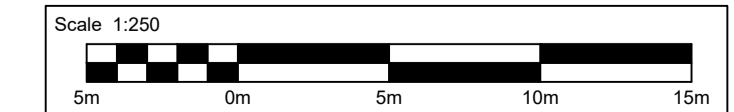

- NOTES:**
- ALL DIMENSIONS ARE IN METRES UNLESS OTHERWISE STATED.
  - EARTHWORKS REQUIREMENTS ARE PENDING DETAILED TOPOGRAPHICAL SURVEY.
  - ALL EARTHWORKS SLOPES TO BE 1(V):3(H) UNLESS OTHERWISE SHOWN.
  - VERGE WIDTHS SHOWN ARE MINIMUM. VERGE WIDTH SHALL BE INCREASED TO PROVIDE SIGHT DISTANCE WHERE REQUIRED.
  - VEGETATION SHOWN 15 YEARS AFTER OPENING.
  - THESE PLANS SHOULD BE READ IN CONJUNCTION WITH SCHEDULE 1 OF THE DEVELOPMENT CONSENT ORDER (TR010034/APP/3.1).
  - THE PROPOSED WORKS WILL BE SUBJECT TO DETAILED DESIGN DEVELOPMENT. ANY CHANGES WILL BE LIMITED TO BEING WITHIN THE DCO BOUNDARY OR THE RELEVANT LIMITS OF DEVIATION, AND SUBJECT TO THE REQUIREMENTS OF SCHEDULE 2 OF THE DEVELOPMENT CONSENT ORDER (TR010034/APP/3.1)

- KEY:**
- PROPOSED TREE AND SHRUB PLANTING
  - EXISTING VEGETATION
  - EXISTING GROUND LEVEL
  - MARGINAL AND EMERGENT VEGETATION
  - PROPOSED OPEN GRASSLAND OR LOW VEGETATION
  - LEVEL OF PROPOSED ROAD WORKS
  - SWC SURFACE WATER CHANNEL
  - E/B C WAY EASTBOUND CARRIAGEWAY
  - W/B C WAY WESTBOUND CARRIAGEWAY

This map is based on Ordnance Survey material with the permission of Ordnance Survey on behalf of the Controller of Her Majesty's Stationery Office. © Crown copyright. Unauthorised reproduction infringes Crown copyright and may lead to prosecution or civil proceedings. Highways England 10003649, 2021.

Description	Status	Revision	Issue Date
<b>DCO APPLICATION</b>	A4	P01	14/05/21

Drawing Suitability	<b>DCO APPLICATION</b>	Status	<b>A4</b>
---------------------	------------------------	--------	-----------

**Client**

**Scheme Name**  
A57 LINK ROADS

**Drawing Title**  
CROSS SECTIONS  
REGULATION 5(2)(o) & 6(2)

**SHEET 1 OF 3**

**PINS Ref No:**  
TR010034/APP/2.7

Drawing Number	Originator	Volume	
HE551473	BBA	LDC	
Location	Type	Role	Number
A57_AL_SCHEME	DR	ZL	020721

Scale	Original Size	Rev:
AS SHOWN @ A1	A1	P01

DO NOT SCALE

Millimetres

0 10 100

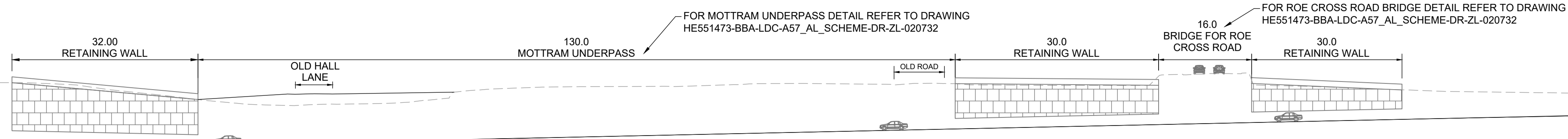

**SECTION-06: A57 LINK ROADS**  
SCALE 1:500

- NOTES:**
- ALL DIMENSIONS ARE IN METRES UNLESS OTHERWISE STATED.
  - EARTHWORKS REQUIREMENTS ARE PENDING DETAILED TOPOGRAPHICAL SURVEY.
  - ALL EARTHWORKS SLOPES TO BE 1(V):3(H) UNLESS OTHERWISE SHOWN.
  - VERGE WIDTHS SHOWN ARE MINIMUM. VERGE WIDTH SHALL BE INCREASED TO PROVIDE SIGHT DISTANCE WHERE REQUIRED.
  - VEGETATION SHOWN 15 YEARS AFTER OPENING.
  - THESE PLANS SHOULD BE READ IN CONJUNCTION WITH SCHEDULE 1 OF THE DEVELOPMENT CONSENT ORDER (TR010034/APP/3.1).
  - THE PROPOSED WORKS WILL BE SUBJECT TO DETAILED DESIGN DEVELOPMENT. ANY CHANGES WILL BE LIMITED TO BEING WITHIN THE DCO BOUNDARY OR THE RELEVANT LIMITS OF DEVIATION, AND SUBJECT TO THE REQUIREMENTS OF SCHEDULE 2 OF THE DEVELOPMENT CONSENT ORDER (TR010034/APP/3.1).

- KEY:**
- PROPOSED TREE AND SHRUB PLANTING
  - EXISTING VEGETATION
  - EXISTING GROUND LEVEL
  - MARGINAL AND EMERGENT VEGETATION
  - PROPOSED OPEN GRASSLAND OR LOW VEGETATION
  - LEVEL OF PROPOSED ROAD WORKS
  - SWC
  - E/B CWAY
  - W/B CWAY

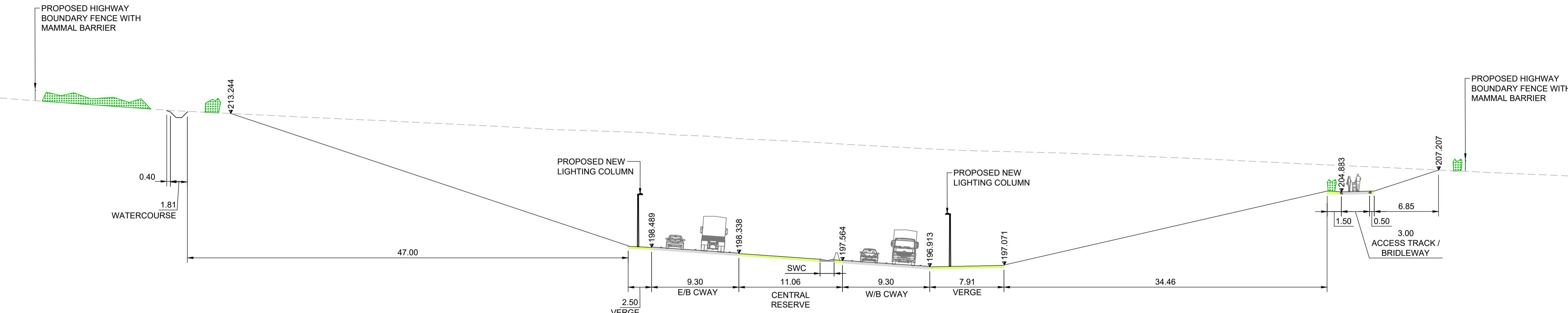

**SECTION-07: A57 LINK ROADS**  
SCALE 1:250

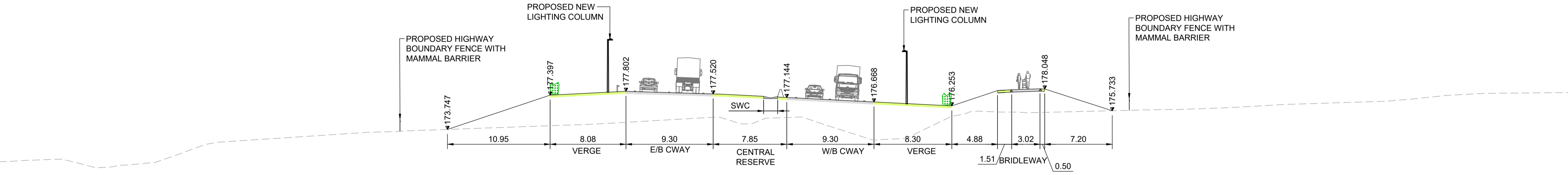

**SECTION-08: A57 LINK ROADS**  
SCALE 1:250

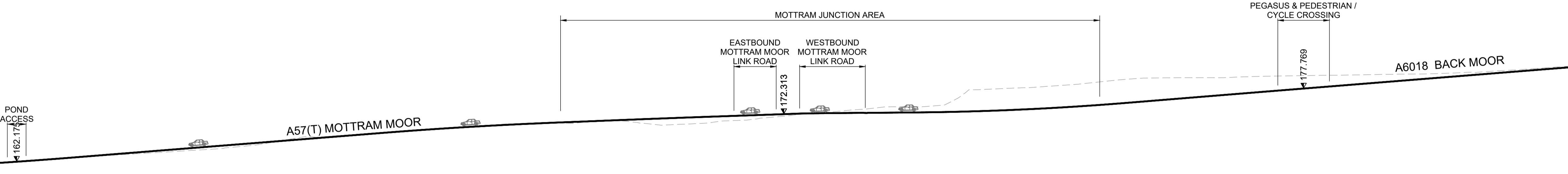

**SECTION-09: A57 LINK ROADS**  
SCALE 1:500

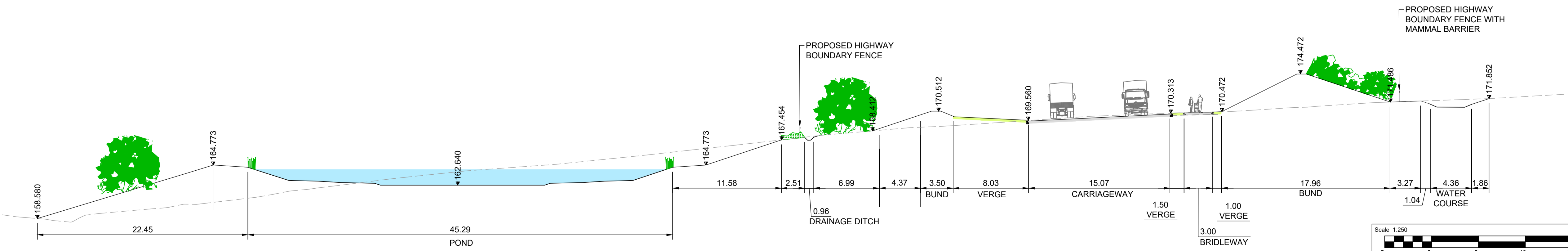

**SECTION-10: A57 LINK ROADS**  
SCALE 1:250

This map is based on Ordnance Survey material with the permission of Ordnance Survey on behalf of the Controller of Her Majesty's Stationary Office. © Crown copyright. Unauthorised reproduction infringes Crown copyright and may lead to prosecution or civil proceedings. Highways England 10003640\_2021.

Description	Status	Revision	Issue Date
DCO APPLICATION	A4	P01	14/05/21

Drawing Suitability: A4

Client: **highways england**

Scheme Name: **A57 LINK ROADS**

Drawing Title: **CROSS SECTIONS REGULATION 5(2)(o) & 6(2)**

SHEET 2 OF 3

PINS Ref No: TR010034/APP/2.7

Drawing Number	Originator	Volume
HE551473	BBA	LDC
A57_AL_SCHEME		DR · ZL · 020722
Location	Type	Role
AS SHOWN @ A1		
Scale	Original Size	Rev
A1	A1	P01



100  
0 10  
Millimetres  
DO NOT SCALE

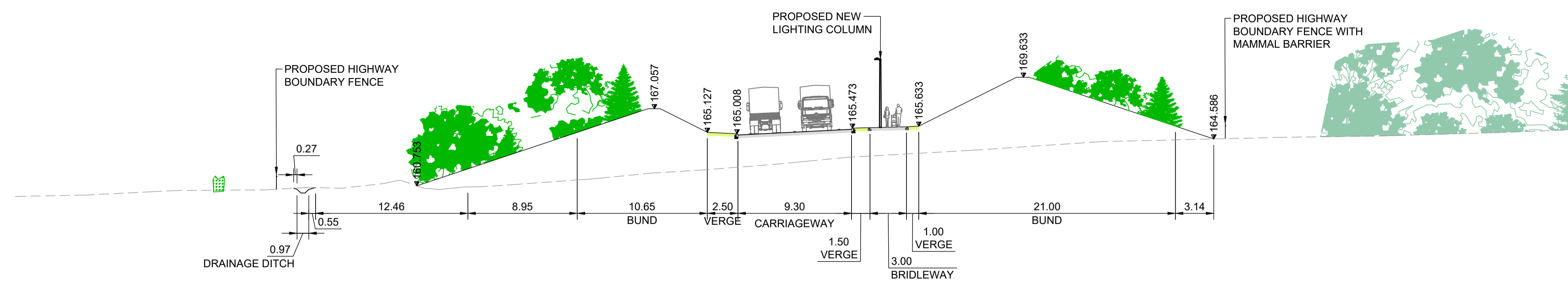

**SECTION-11 : A57 LINK ROADS**  
SCALE 1:250

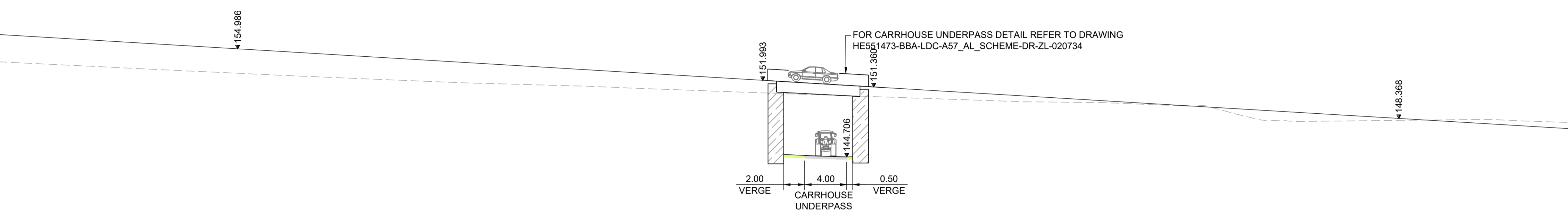

**SECTION-12 : A57 LINK ROADS**  
SCALE 1:250

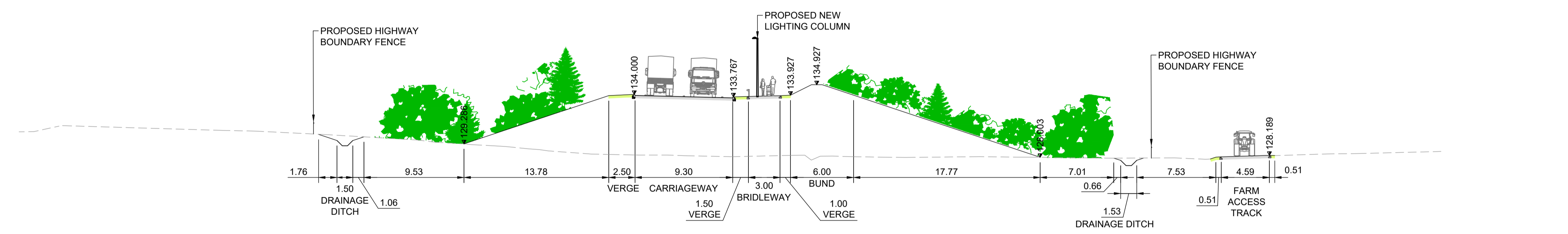

**SECTION-13 : A57 LINK ROADS**  
SCALE 1:250

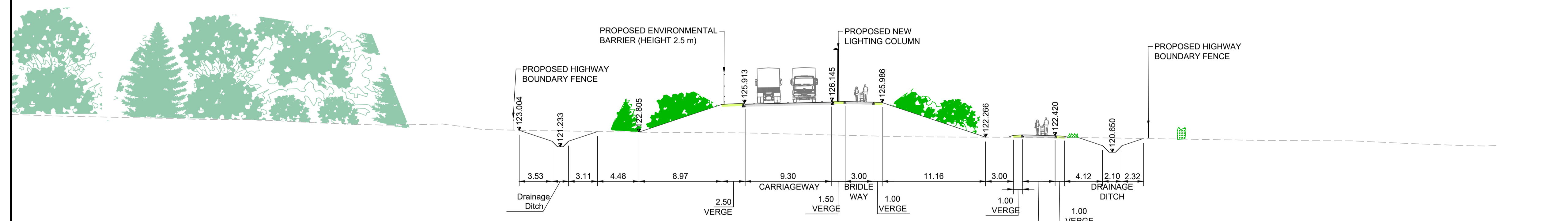

**SECTION-14 : A57 LINK ROADS**  
SCALE 1:250

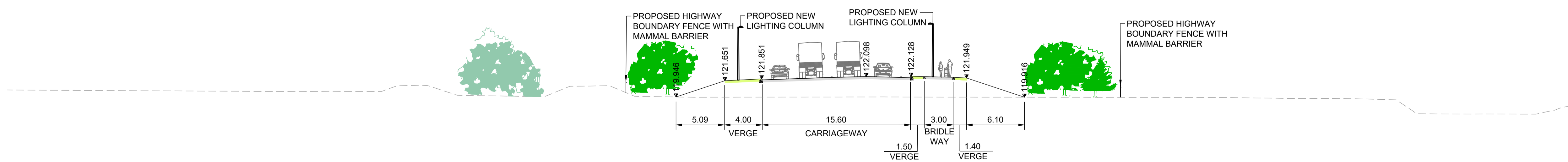

**SECTION-15 : A57 LINK ROADS**  
SCALE 1:250

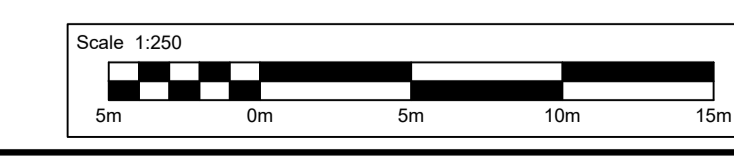

- NOTES:**
1. ALL DIMENSIONS ARE IN METRES UNLESS OTHERWISE STATED.
  2. EARTHWORKS REQUIREMENTS ARE PENDING DETAILED TOPOGRAPHICAL SURVEY.
  3. ALL EARTHWORKS SLOPES TO BE 1(V):3(H) UNLESS OTHERWISE SHOWN.
  4. VERGE WIDTHS SHOWN ARE MINIMUM. VERGE WIDTH SHALL BE INCREASED TO PROVIDE SIGHT DISTANCE WHERE REQUIRED.
  5. VEGETATION SHOWN 15 YEARS AFTER OPENING.
  6. THESE PLANS SHOULD BE READ IN CONJUNCTION WITH SCHEDULE 1 OF THE DEVELOPMENT CONSENT ORDER (TR010034/APP/3.1).
  7. THE PROPOSED WORKS WILL BE SUBJECT TO DETAILED DESIGN DEVELOPMENT. ANY CHANGES WILL BE LIMITED TO BEING WITHIN THE DCO BOUNDARY OR THE RELEVANT LIMITS OF DEVIATION, AND SUBJECT TO THE REQUIREMENTS OF SCHEDULE 2 OF THE DEVELOPMENT CONSENT ORDER (TR010034/APP/3.1)

- KEY:**
- PROPOSED TREE AND SHRUB PLANTING
  - EXISTING VEGETATION
  - EXISTING GROUND LEVEL
  - MARGINAL AND EMERGENT VEGETATION
  - PROPOSED OPEN GRASSLAND OR LOW VEGETATION
  - LEVEL OF PROPOSED ROAD WORKS
  - SWC SURFACE WATER CHANNEL
  - E/B CWAY EASTBOUND CARRIAGEWAY
  - W/B CWAY WESTBOUND CARRIAGEWAY

This map is based on Ordnance Survey material with the permission of Ordnance Survey on behalf of the Controller of Her Majesty's Stationary Office. © Crown copyright. Unauthorised reproduction infringes Crown copyright and may lead to prosecution or civil proceedings. Highways England, 10003640, 2021.

Description	Status	Revision	Issue Date

Description DCO APPLICATION			
Status	A4	Revision	P01
Issue Date	14/05/21		

Drawing Suitability	DCO APPLICATION		Status	A4
---------------------	-----------------	--	--------	----



Scheme Name  
**A57 LINK ROADS**

Drawing Title  
**CROSS SECTIONS  
REGULATION 5(2)(o) & 6(2)**

**SHEET 3 OF 3**

PINS Ref No:  
TR010034/APP/2.7

Drawing Number	HE551473	Originator	BBA	Volume	LDC
Scheme	A57_AL_SCHEME - DR - ZL - 020723				

Location	AS SHOWN @ A1	Original Size	A1	Rev:	P01
----------	---------------	---------------	----	------	-----

DO NOT SCALE

Millimetres

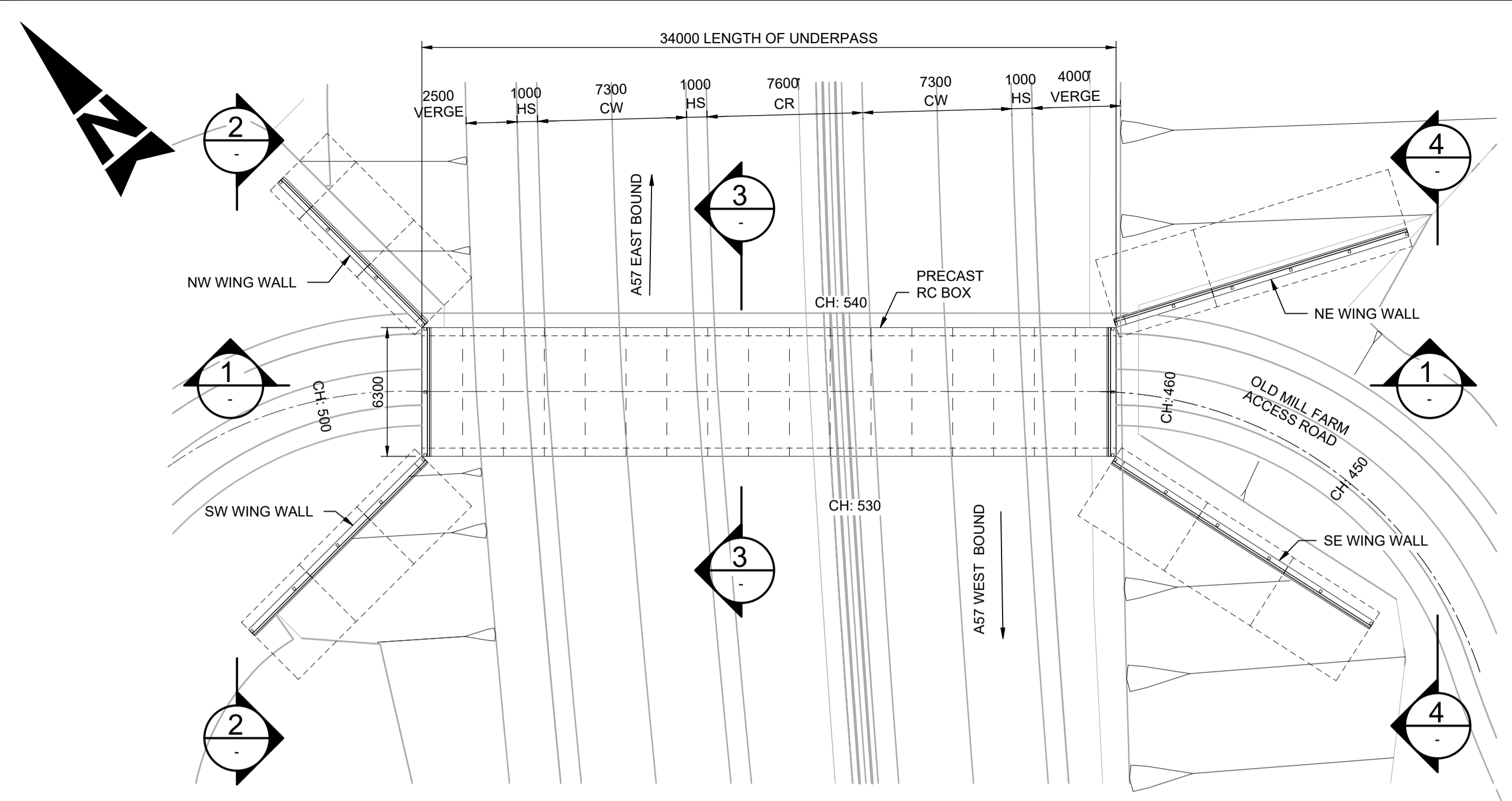

**PLAN**  
SCALE 1 : 200

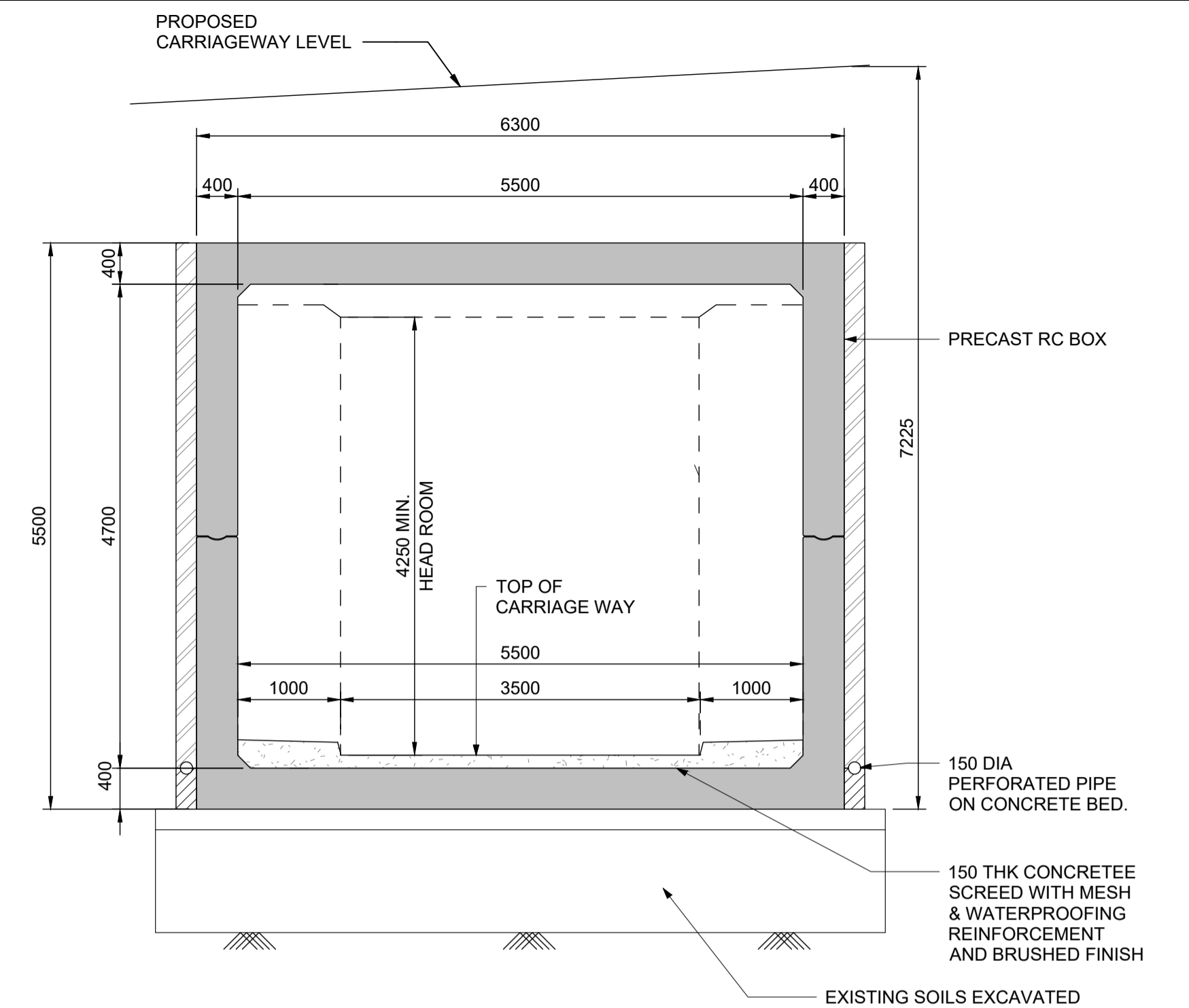
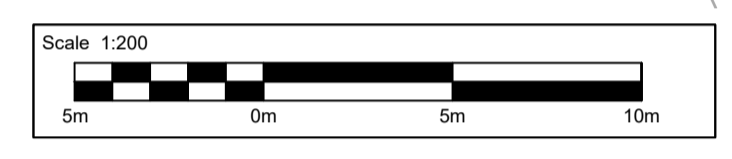

**3 SECTION**  
SCALE 1 : 50

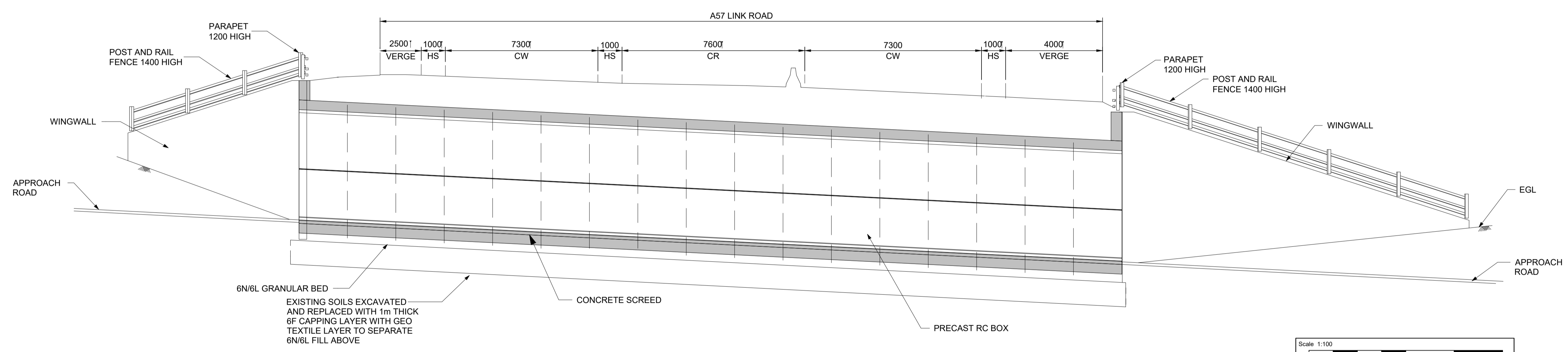
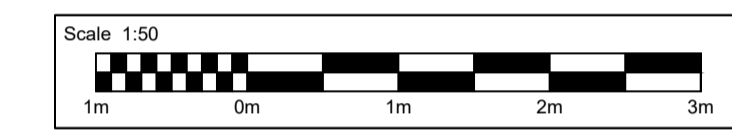

**1 SECTION**  
SCALE 1 : 100

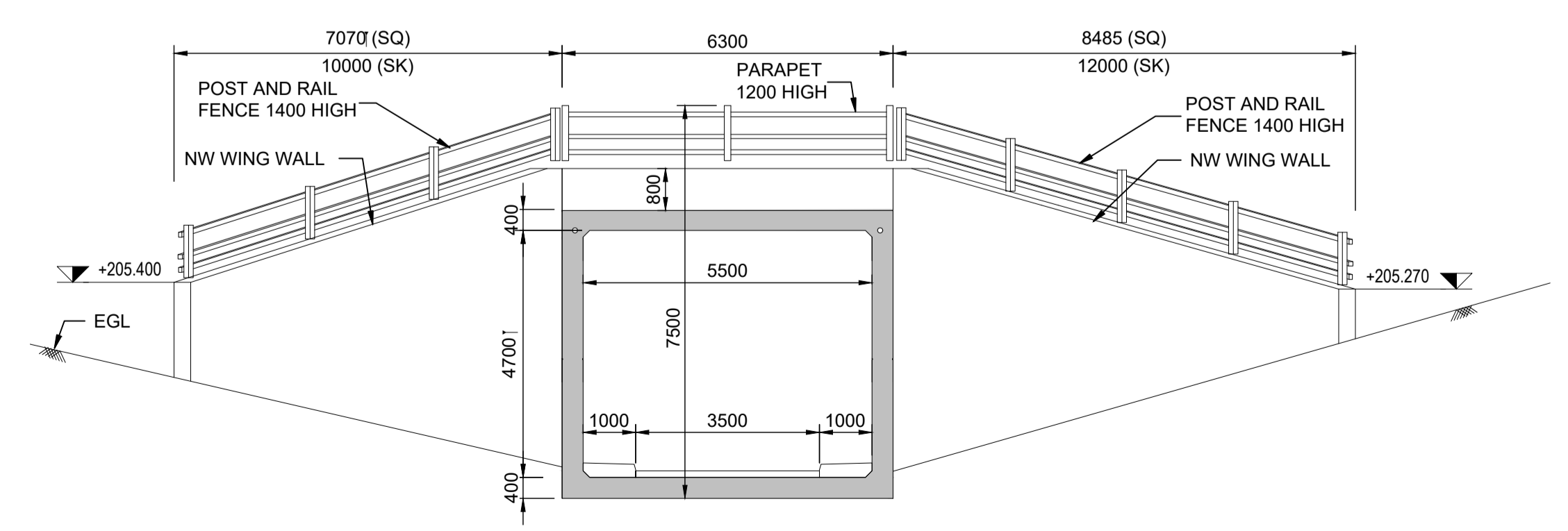
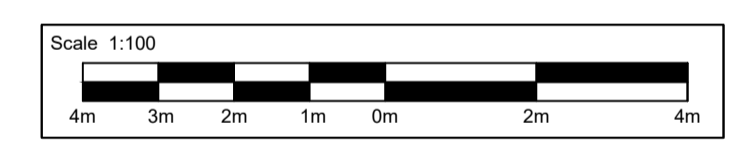

**2 ELEVATION**  
SCALE 1 : 100

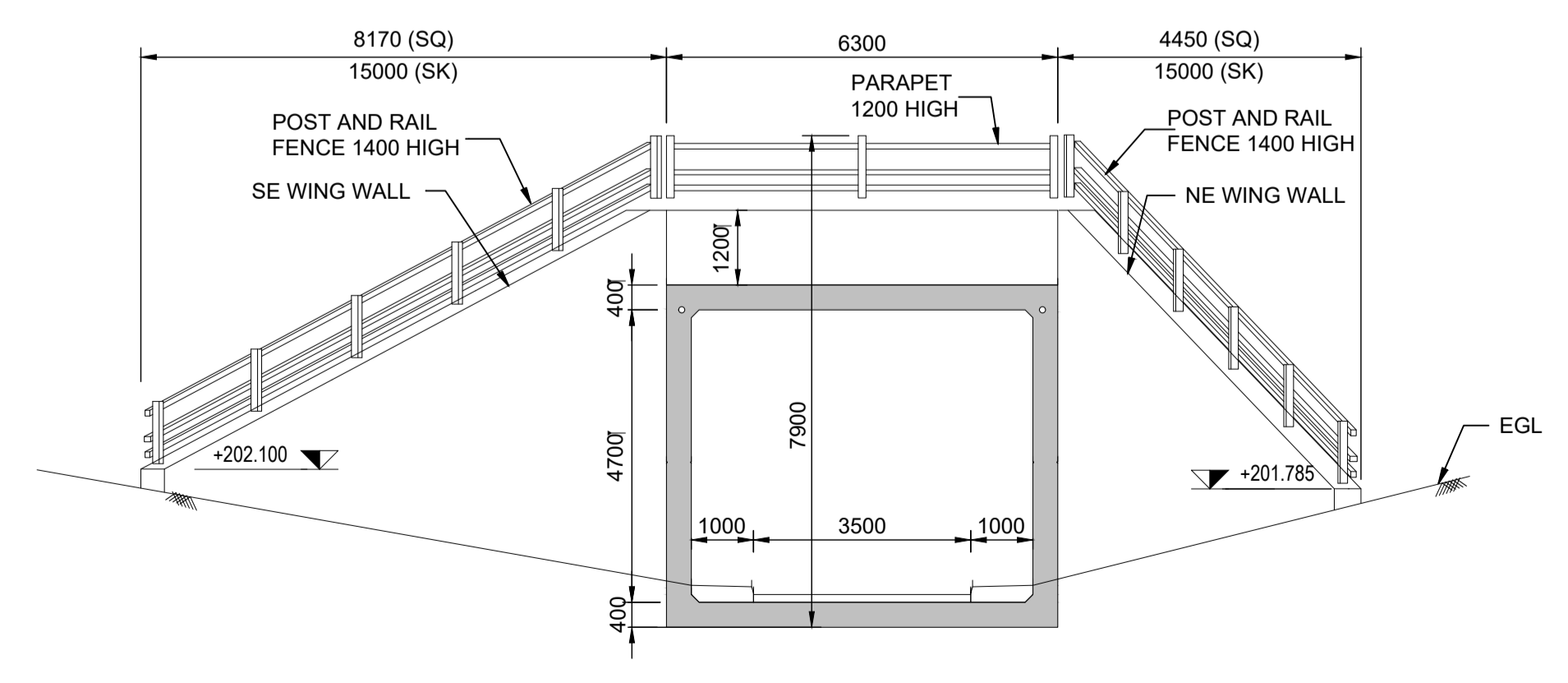
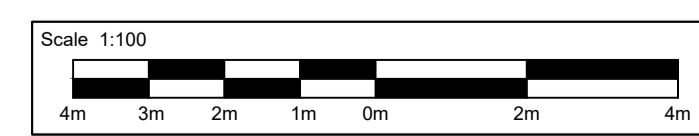

**4 ELEVATION**  
SCALE 1 : 100

- NOTES:**
- ALL DIMENSIONS ARE IN MILLIMETRES UNLESS NOTED OTHERWISE.
  - THESE PLANS SHOULD BE READ IN CONJUNCTION WITH SCHEDULE 1 OF THE DEVELOPMENT CONSENT ORDER (TR010034/APP/3.1).
  - THE PROPOSED WORKS WILL BE SUBJECT TO DETAILED DESIGN DEVELOPMENT. ANY CHANGES WILL BE LIMITED TO BEING WITHIN THE DCO BOUNDARY OR THE RELEVANT LIMITS OF DEVIATION, AND SUBJECT TO THE REQUIREMENTS OF SCHEDULE 2 OF THE DEVELOPMENT CONSENT ORDER (TR010034/APP/3.1)

- ABBREVIATIONS:**
- SQ - SQUARE
  - SK - SKEW
  - FGL - FINISH GROUND LEVEL
  - EGL - EXISTING GROUND LEVEL
  - TYP - TYPICAL
  - HS - HARD STRIP
  - THK - THICK
  - CH - CHAINAGE
  - DIA - DIAMETER
  - HS - HARD STRIP
  - CW - CARRIAGEWAY
  - NW - NORTH WEST
  - NE - NORTH EAST
  - SE - SOUTH EAST
  - SW - SOUTH WEST
  - m - METRES
  - RC - REINFORCED CONCRETE
  - CR - CENTRAL RESERVE

This map is based on Ordnance Survey material with the permission of Ordnance Survey on behalf of the Controller of Her Majesty's Stationary Office. © Crown copyright. Unauthorised reproduction infringes Crown copyright and may lead to prosecution or civil proceedings. Highways England, 100030640, 2021.

Description	Status	Revision	Issue Date
DCO APPLICATION	A4	P01	14/05/21

Drawing Suitability	DCO APPLICATION	Status	A4
Client			
Scheme Name	A57 LINK ROADS		
Drawing Title	STRUCTURE DETAILS OLD MILL FARM UNDERPASS REGULATION 5(2)(o) & 6(2) SHEET 1 OF 5		
PINS Ref No:	TR010034/APP/2.7		
Drawing Number	HE551473	Originator	BBA
Scheme	A57_AL_SCHEME	Volume	LDC
Location	AS SHOWN @ A1	Type	DR · ZL · 020731
Scale	Original Size	A1	Rev: P01

100  
10  
0  
10  
DO NOT SCALE

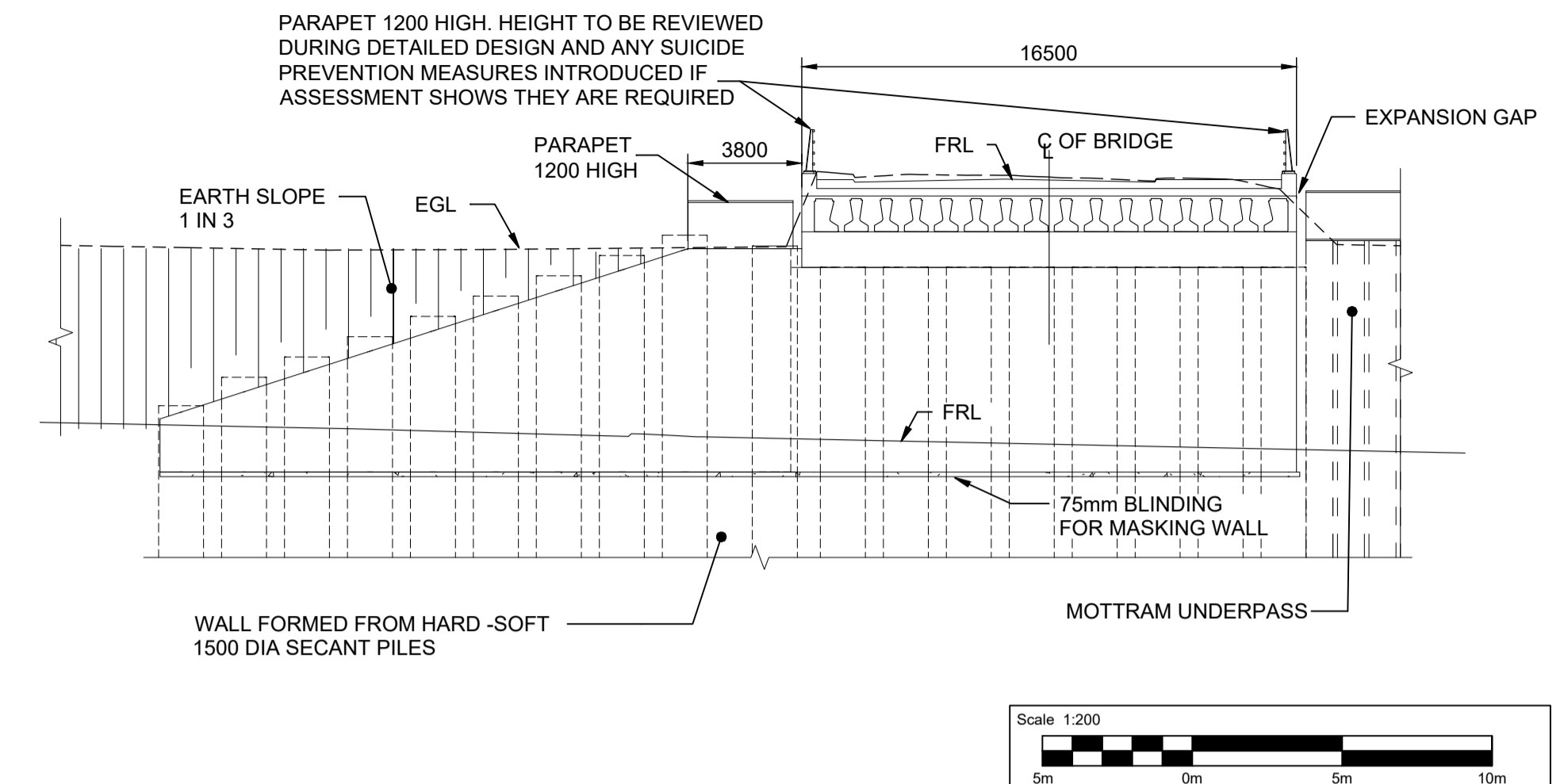
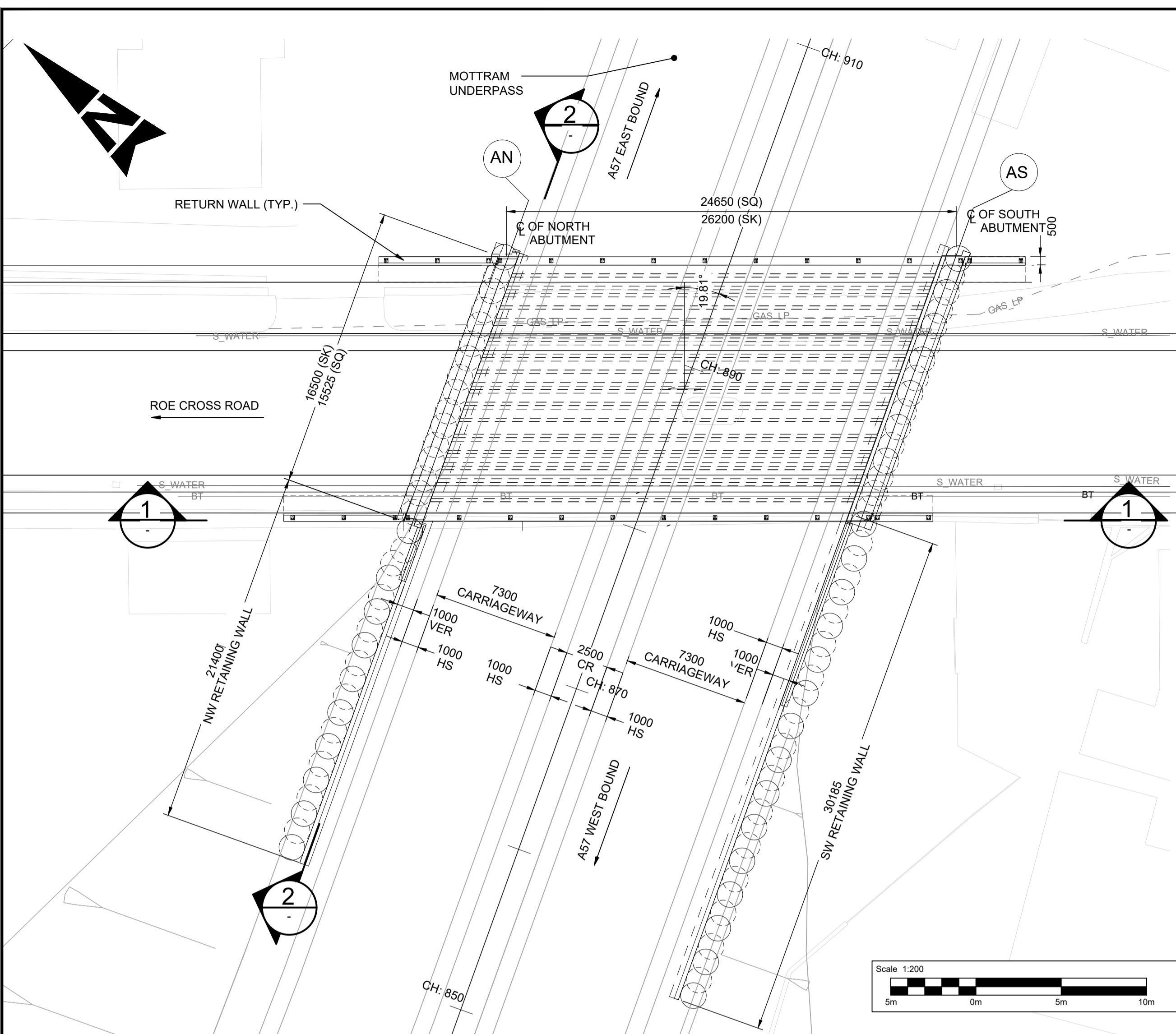

- NOTES:**
- ALL DIMENSIONS ARE IN MILLIMETRES AND ALL LEVELS ARE IN METRES UNLESS OTHERWISE NOTED.
  - FULL LENGTH OF PILES NOT SHOWN.
  - EXISTING ROAD AND GROUND LEVELS TO BE REINSTATED ON COMPLETION.
  - STATUTORY UNDERTAKERS APPARATUS TO BE REINSTATED AS AGREED WITH UTILITY COMPANIES.
  - THESE PLANS SHOULD BE READ IN CONJUNCTION WITH SCHEDULE 1 OF THE DEVELOPMENT CONSENT ORDER (TR010034/APP/3.1).
  - THE PROPOSED WORKS WILL BE SUBJECT TO DETAILED DESIGN DEVELOPMENT. ANY CHANGES WILL BE LIMITED TO BEING WITHIN THE DCO BOUNDARY OR THE RELEVANT LIMITS OF DEVIATION, AND SUBJECT TO THE REQUIREMENTS OF SCHEDULE 2 OF THE DEVELOPMENT CONSENT ORDER (TR010034/APP/3.1)

- ABBREVIATIONS:**
- Q - CENTRE LINE
  - TYP - TYPICAL
  - FGL - FINISH GROUND LEVEL
  - EGL - EXISTING GROUND LEVEL HS
  - FP - FOOTPATH
  - CR - CENTRAL RESERVE
  - VER - VERGE
  - CH - CHAINAGE
  - FRL - FINISHED ROAD LEVEL
  - THK - THICK
  - m - METRES
  - SQ - SQUARE
  - SK - SKEW
  - VRS - VEHICLE RESTRAINT SYSTEM

- LEGEND:**
- S\_WATER- - SURFACE WATER
  - GAS\_LP- - GAS LOW PRESSURE
  - BT- - TELECOMMUNICATIONS CABLE

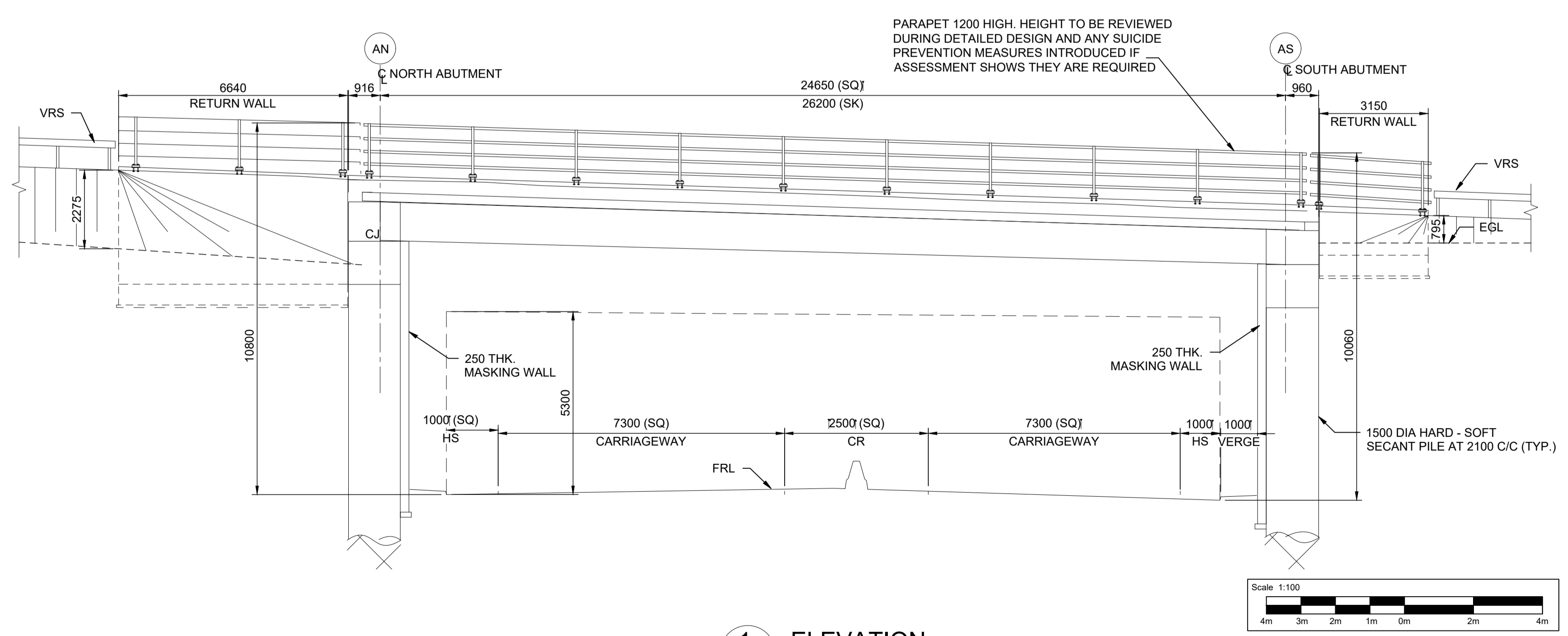

This map is based on Ordnance Survey material with the permission of Ordnance Survey on behalf of the Controller of Her Majesty's Stationary Office. © Crown copyright. Unauthorised reproduction infringes Crown copyright and may lead to prosecution or civil proceedings. Highways England, 100032640, 2021.

Status	Revision	Issue Date
DCO APPLICATION		
Status	Revision	Issue Date
A4	P01	14/05/21

Drawing Suitability	DCO APPLICATION		Status	A4
Client				
Scheme Name	A57 LINK ROADS			
Drawing Title	STRUCTURE DETAILS ROE CROSS ROAD UNDERPASS REGULATION 5(2)(o) & 6(2) SHEET 2 OF 5			
PINS Ref No:	TR010034/APP/2.7			
Drawing Number	Originator	Volume		
HE551473	BBA	LDC		
A57_AL_SCHEME		DR	ZL	020732
Location	Type	Role	Number	
AS SHOWN @ A1	Original Size	A1	Rev: P01	

DO NOT SCALE

100  
0 10  
Millimetres

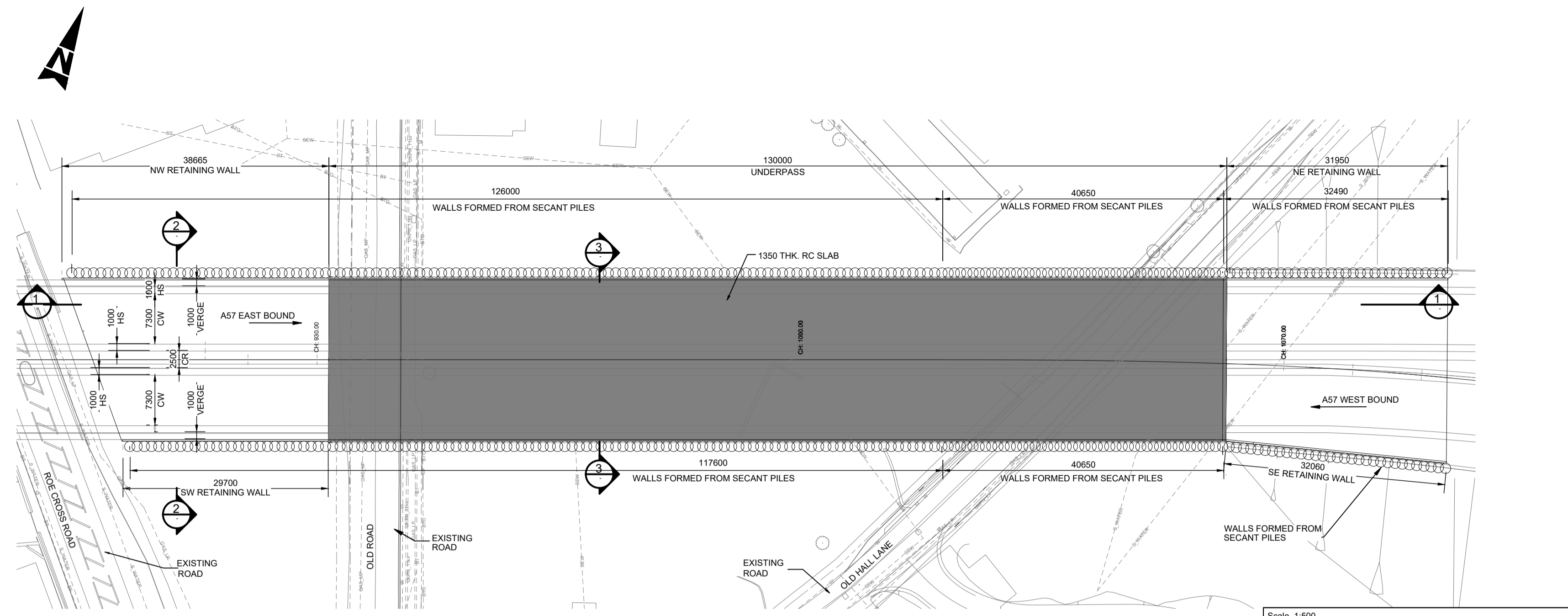

**MOTTRAM UNDERPASS PLAN**  
SCALE 1 : 500

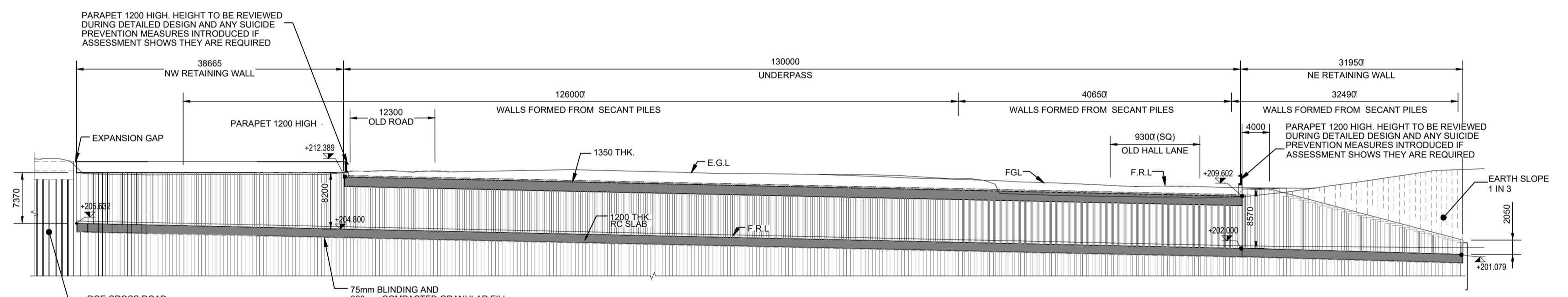
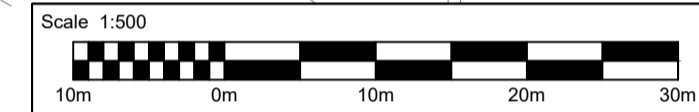

**1 SECTION**  
SCALE 1 : 500

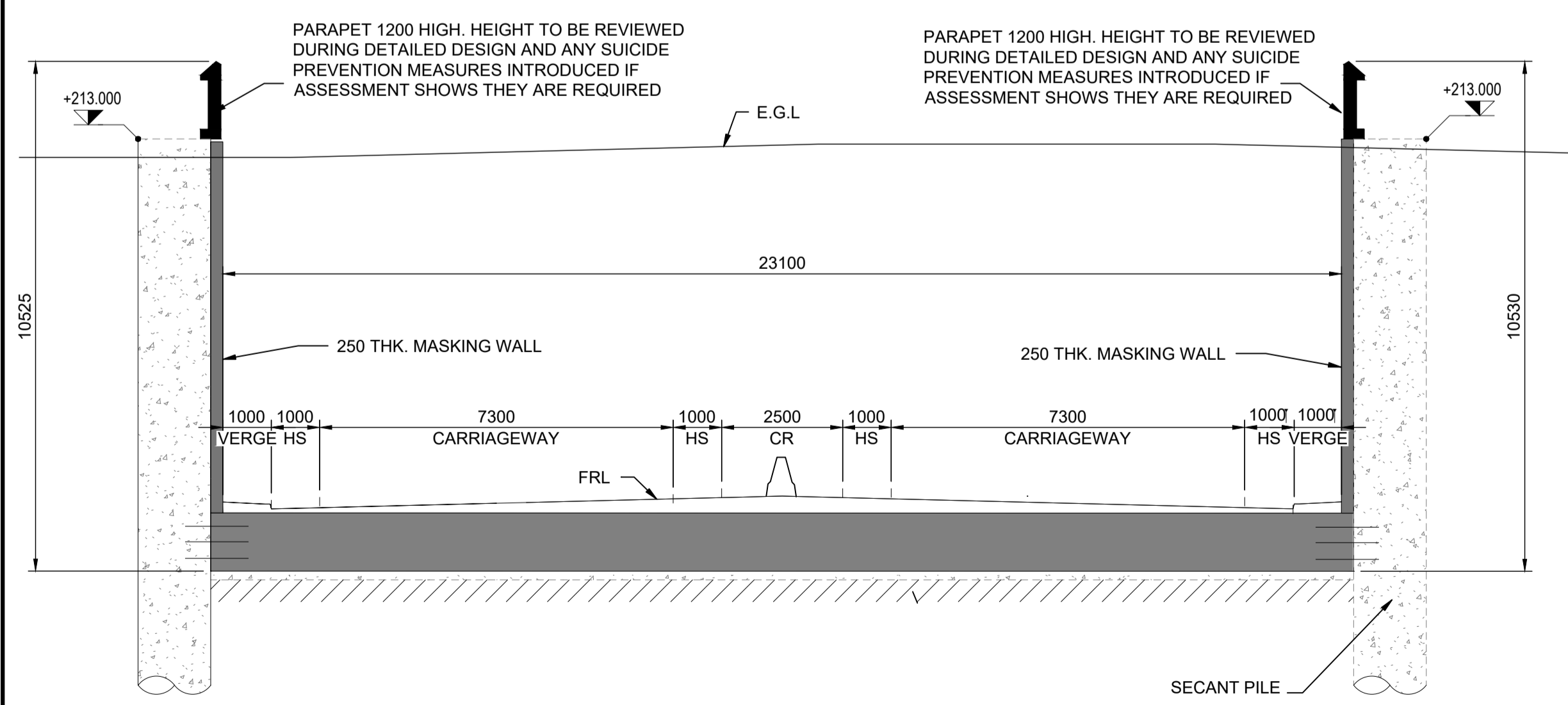
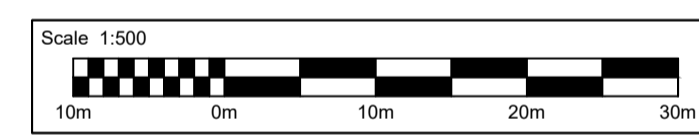

**2 TYPICAL SECTION AT WEST RETAINING WALL**  
SCALE 1 : 100

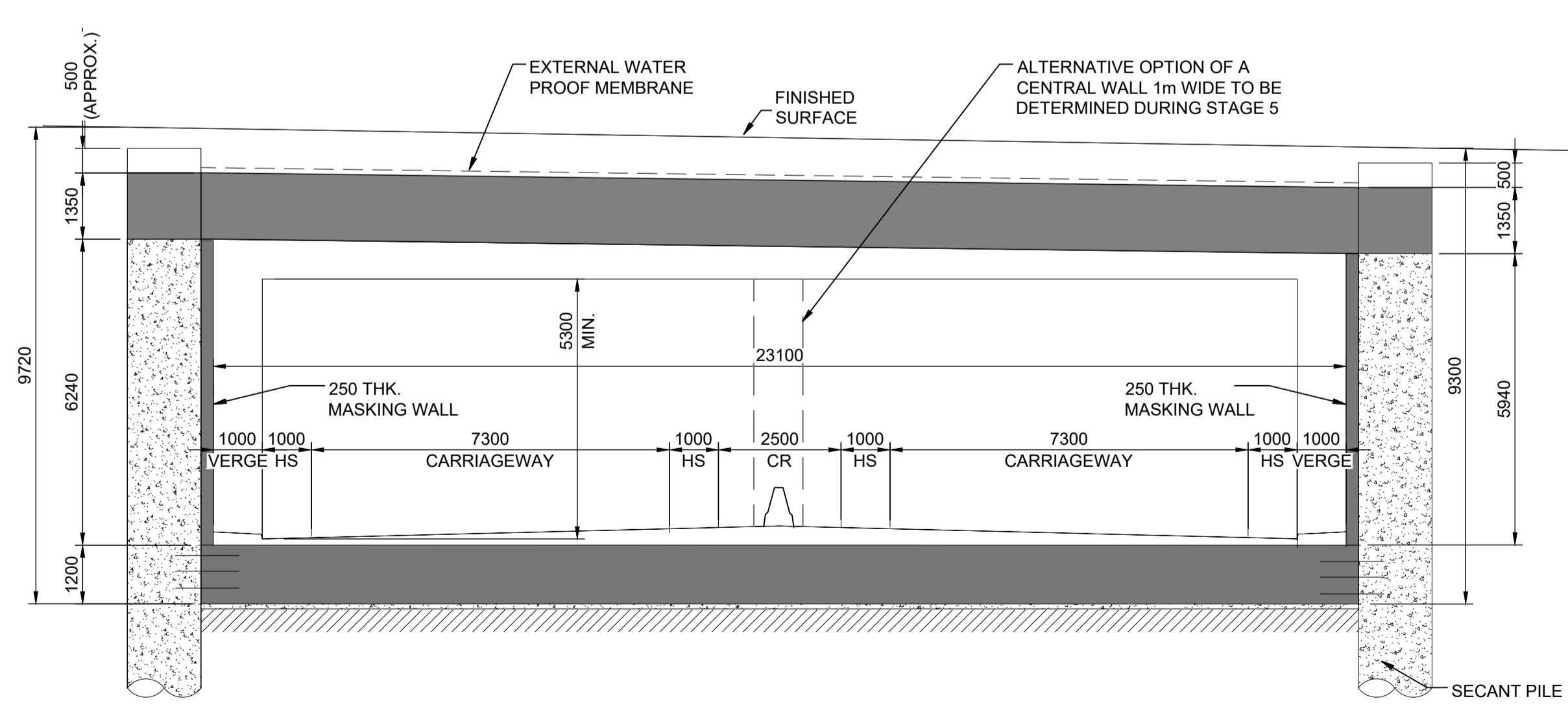
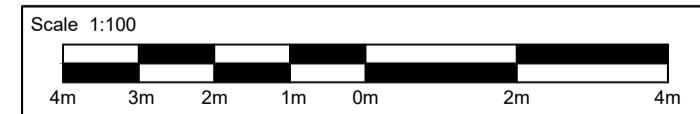

**3 TYPICAL SECTION AT UNDERPASS**  
SCALE 1 : 100

- NOTES:**
- ALL DIMENSIONS ARE IN MILLIMETRES AND ALL LEVELS ARE IN METRES UNLESS OTHERWISE NOTED.
  - EXISTING ROAD AND GROUND LEVELS TO BE REINSTATED ON COMPLETION.
  - STATUTORY UNDERTAKERS APPARATUS TO BE REINSTATED AS AGREED WITH UTILITY COMPANIES.
  - SECANT PILE DIA AND SPACING TO BE CONFIRMED.
  - FULL LENGTH OF PILES NOT SHOWN.
  - THESE PLANS SHOULD BE READ IN CONJUNCTION WITH SCHEDULE 1 OF THE DEVELOPMENT CONSENT ORDER (TR010034/APP/3.1).
  - THE PROPOSED WORKS WILL BE SUBJECT TO DETAILED DESIGN DEVELOPMENT. ANY CHANGES WILL BE LIMITED TO BEING WITHIN THE DCO BOUNDARY OR THE RELEVANT LIMITS OF DEVIATION, AND SUBJECT TO THE REQUIREMENTS OF SCHEDULE 2 OF THE DEVELOPMENT CONSENT ORDER (TR010034/APP/3.1)

- ABBREVIATIONS:**
- Q - CENTRE LINE
  - TYP - TYPICAL
  - FGL - FINISH GROUND LEVEL
  - EGL - EXISTING GROUND LEVEL
  - CW - CARRIAGEWAY
  - HS - HARD STRIP
  - FP - FOOTPATH
  - CR - CENTRAL RESERVE
  - CH - CHAINAGE
  - FRL - FINISHED ROAD LEVEL
  - SS - SEPARATION STRIP
  - THK - THICK
  - NW - NORTH WEST
  - NE - NORTH EAST
  - SE - SOUTH EAST
  - SW - SOUTH WEST
  - m - METRES

- LEGEND:**
- SURFACE WATER
  - ELECTRIC 11kw
  - ELECTRIC LOW VOLTAGE
  - COMBINED SEWERS
  - GAS LOW PRESSURE
  - MAIN WATER DISTRIBUTION
  - TELECOMMUNICATIONS CABLE
  - TELECOMMUNICATIONS OVERHEAD

This map is based on Ordnance Survey material with the permission of Ordnance Survey on behalf of the Controller of Her Majesty's Stationary Office. © Crown copyright. Unauthorised reproduction infringes Crown copyright and may lead to prosecution or civil proceedings. Highways England, 100030640, 2021.

Status	Revision	Issue Date

DCO APPLICATION		
Status	Revision	Issue Date
A4	P01	14/05/21

Drawing Suitability	Status
DCO APPLICATION	A4



**Scheme Name**  
A57 LINK ROADS

**Drawing Title**  
STRUCTURE DETAILS  
MOTTRAM UNDERPASS  
REGULATION 5(2)(o) & 6(2)  
SHEET 3 OF 5

**PINS Ref No:** TR010034/APP/2.7

Drawing Number	Originator	Volume	
HE551473	BBA	LDC	
Location	Type	Role	Number
A57_AL_SCHEME	DR	ZL	020733
Scale	Original Size	Rev:	
AS SHOWN @ A1	A1	P01	

DO NOT SCALE

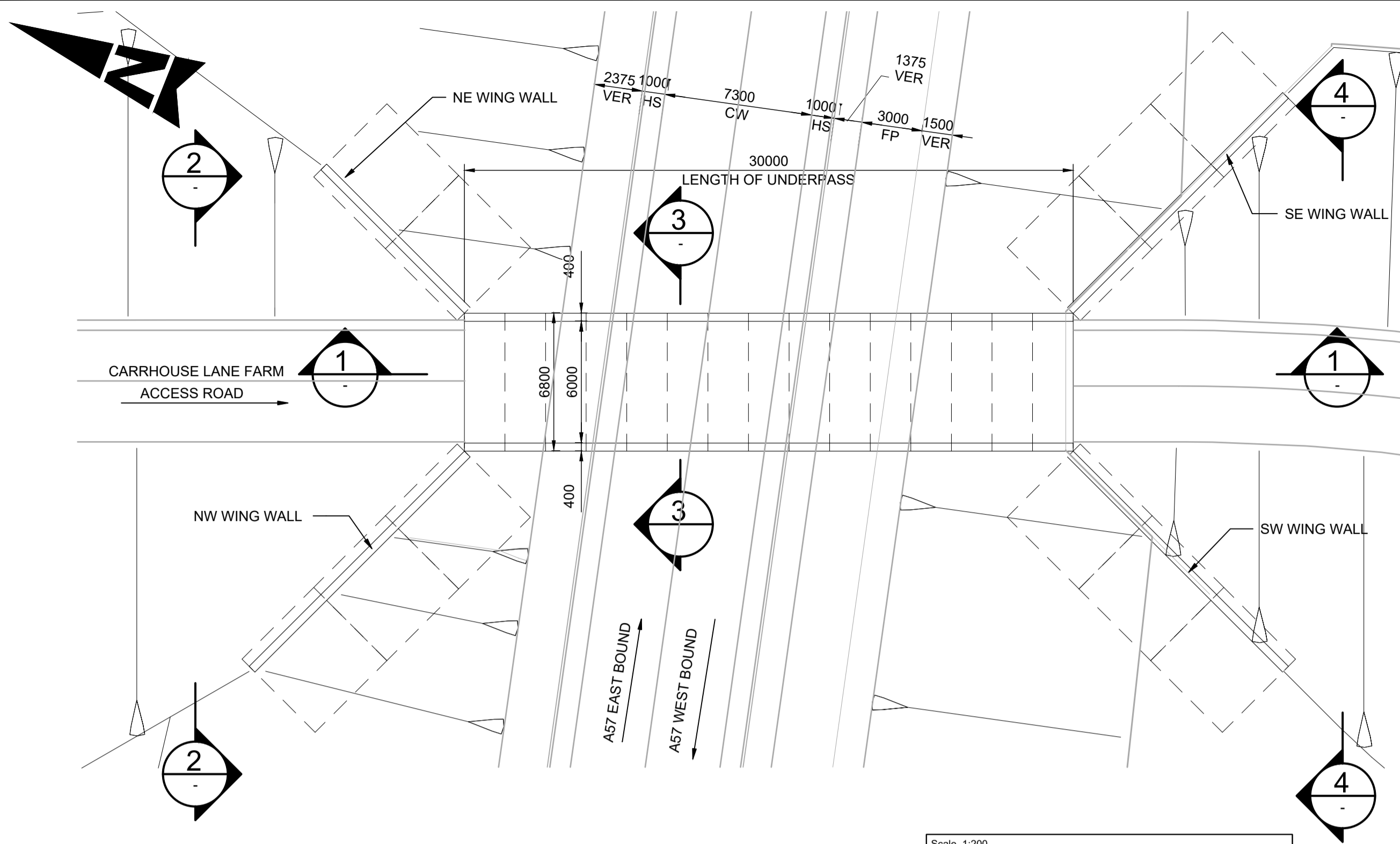

**PLAN**  
SCALE 1 : 200

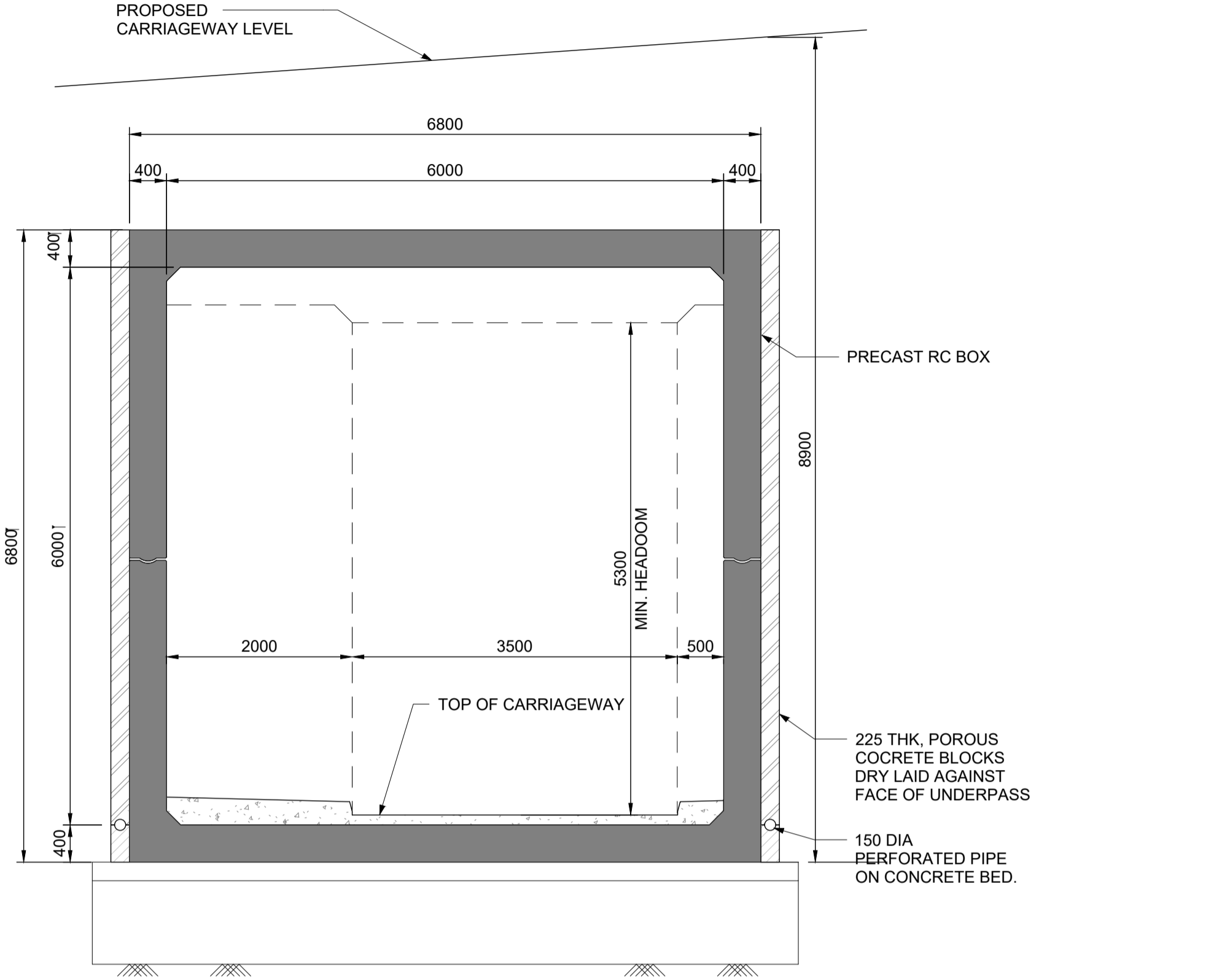
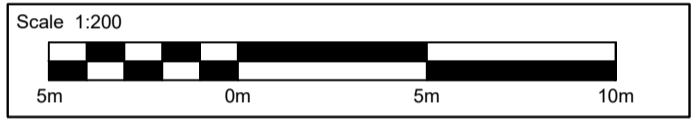

**3 SECTION**  
SCALE 1 : 50

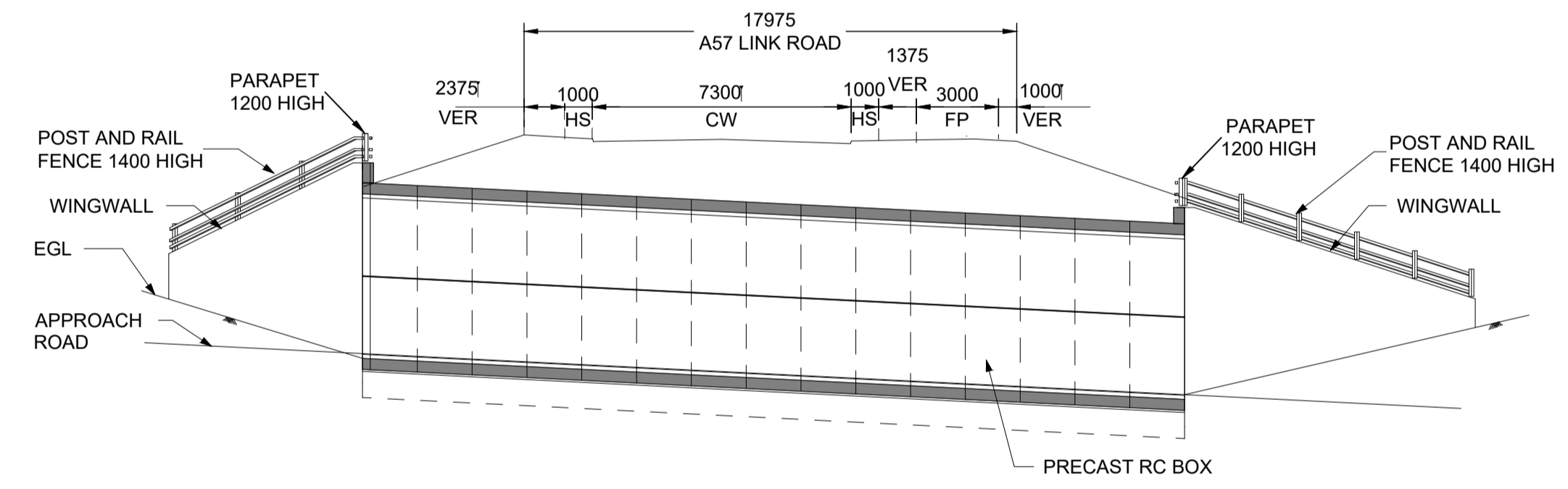
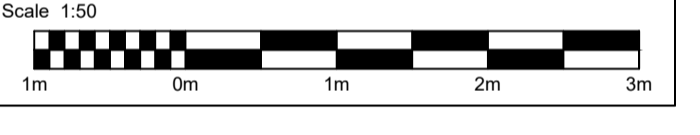

**1 SECTION**  
SCALE 1 : 200

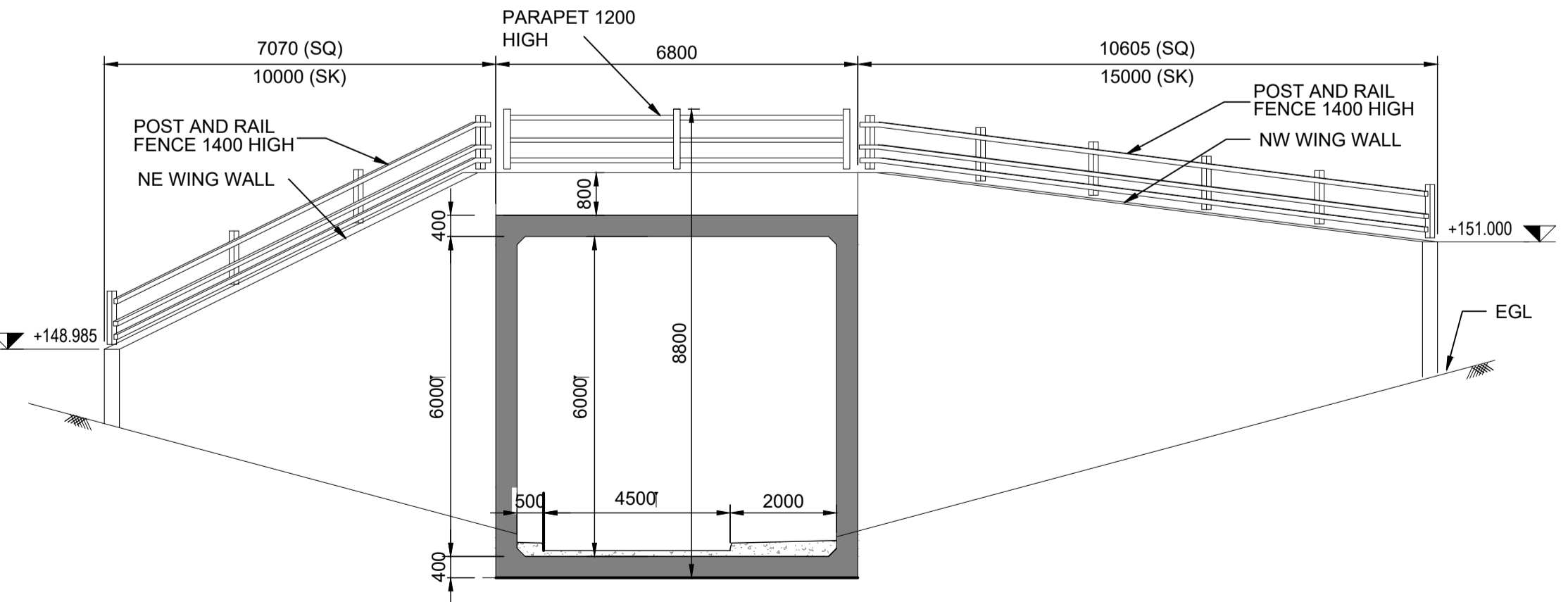
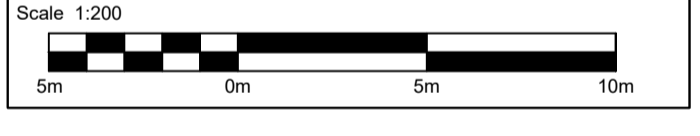

**2 ELEVATION**  
SCALE 1 : 100

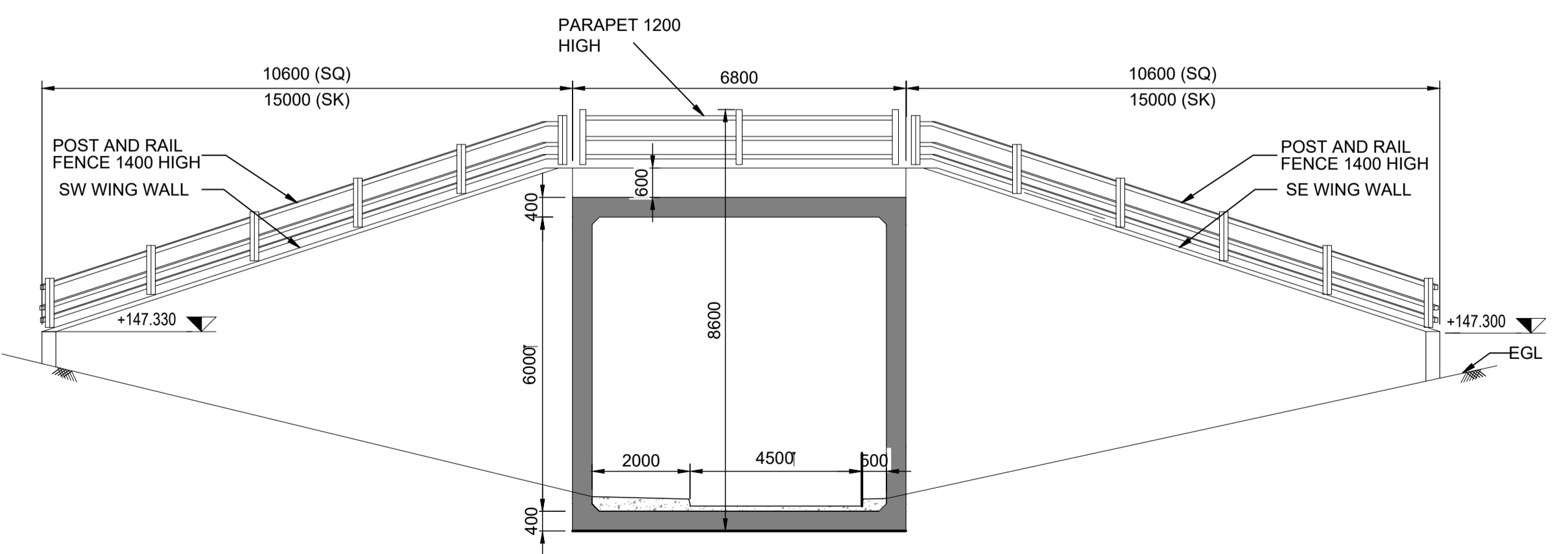

**4 ELEVATION**  
SCALE 1 : 100

- NOTES:**
- ALL DIMENSIONS ARE IN MILLIMETRES UNLESS NOTED OTHERWISE.
  - THESE PLANS SHOULD BE READ IN CONJUNCTION WITH SCHEDULE 1 OF THE DEVELOPMENT CONSENT ORDER (TR010034/APP/3.1).
  - THE PROPOSED WORKS WILL BE SUBJECT TO DETAILED DESIGN DEVELOPMENT. ANY CHANGES WILL BE LIMITED TO BEING WITHIN THE DCO BOUNDARY OR THE RELEVANT LIMITS OF DEVIATION, AND SUBJECT TO THE REQUIREMENTS OF SCHEDULE 2 OF THE DEVELOPMENT CONSENT ORDER (TR010034/APP/3.1).

- ABBREVIATIONS:**
- SQ - SQUARE
  - SK - SKEW
  - FGL - FINISH GROUND LEVEL
  - EGL - EXISTING GROUND LEVEL
  - HS - HARD STRIP
  - FP - FOOTPATH
  - THK - THICK
  - CH - CHAINAGE
  - HS - HARD STRIP
  - CW - CARRIAGEWAY
  - VER - VERGE
  - NW - NORTH WEST
  - NE - NORTH EAST
  - SE - SOUTH EAST
  - SW - SOUTH WEST
  - TYP - TYPICAL
  - DIA - DIAMETER
  - m - METRES
  - RC - REINFORCED CONCRETE

This map is based on Ordnance Survey material with the permission of Ordnance Survey on behalf of the Controller of Her Majesty's Stationary Office. © Crown copyright. Unauthorised reproduction infringes Crown copyright and may lead to prosecution or civil proceedings. Highways England 10003649, 2021.

Status	Revision	Issue Date

Status	Revision	Issue Date
A4	P01	14/05/21

Drawing Suitability	DCO APPLICATION	Status	A4
---------------------	-----------------	--------	----



Scheme Name: **A57 LINK ROADS**

Drawing Title: **STRUCTURE DETAILS  
CARRHOUSE LANE UNDERPASS  
REGULATION 5(2)(a) & 6(2)  
SHEET 4 OF 5**

PINS Ref No: **TR010034/APP/2.7**

Drawing Number	HE551473	Originator	BBA	Volume	LDC
Location	A57_AL_SCHEME	Type	DR	Role	ZL
Scale	AS SHOWN @ A1	Original Size	A1	Rev	P01

DO NOT SCALE

Millimetres

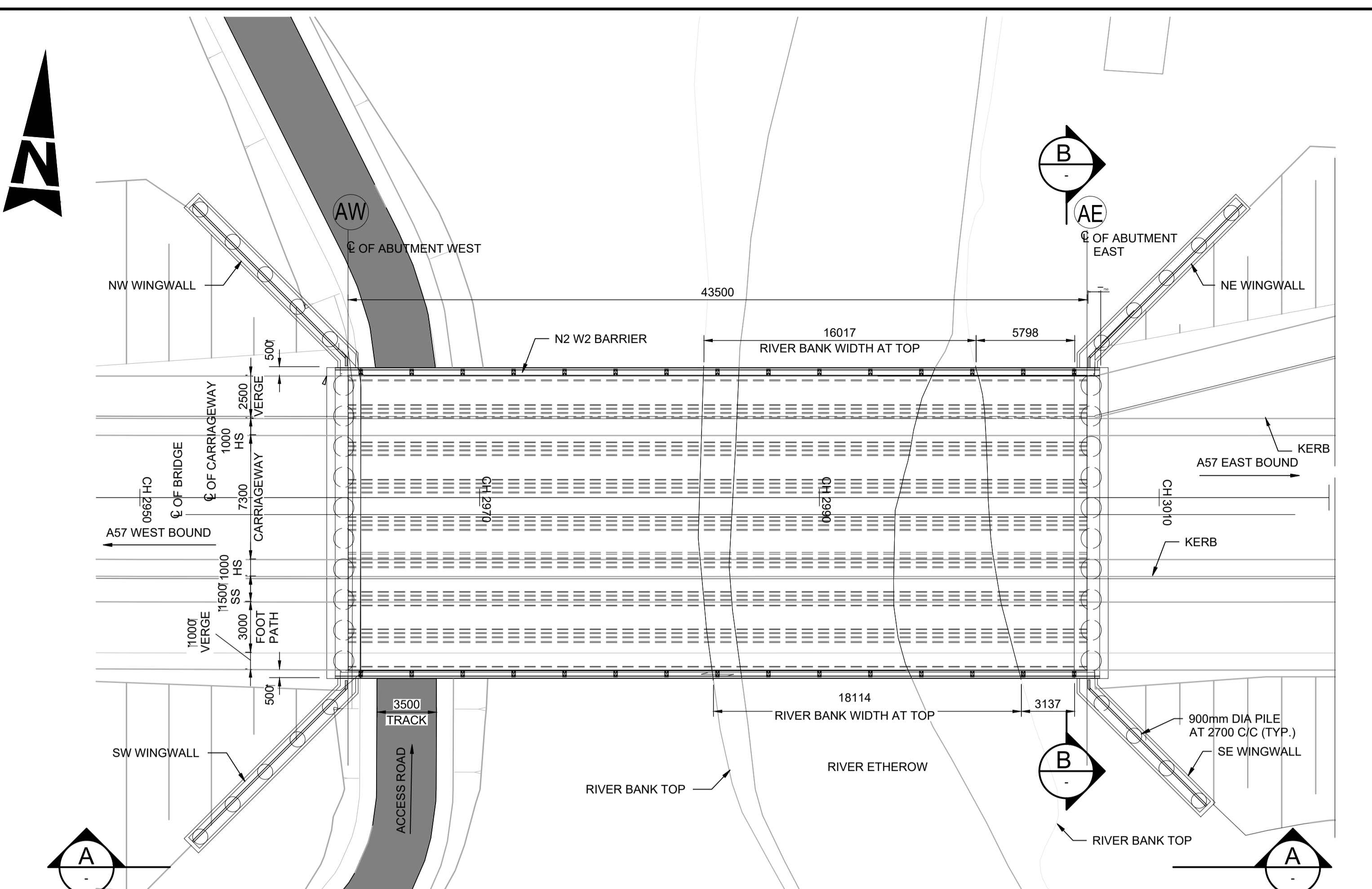

PLAN ON DECK SCALE 1:200

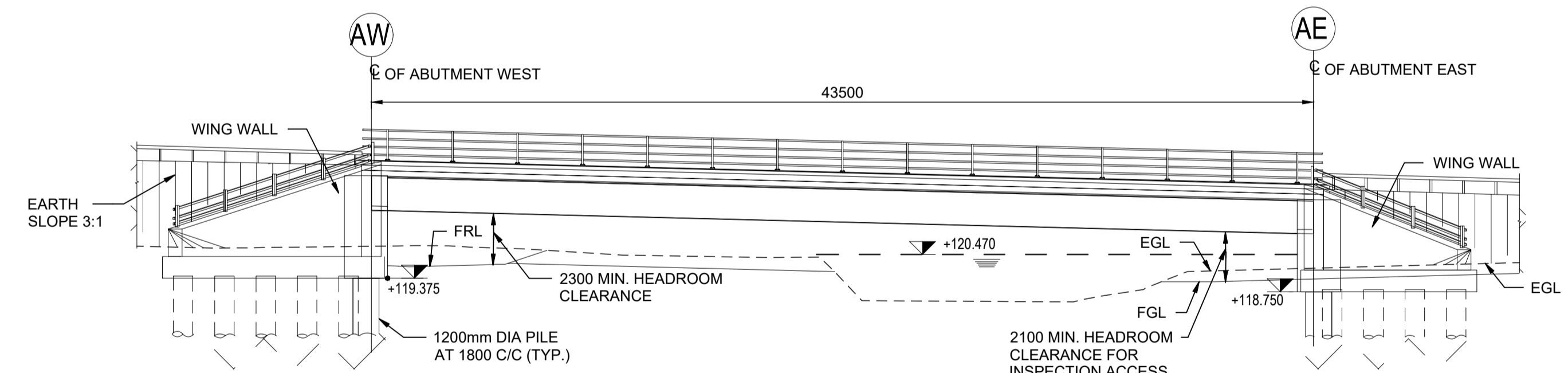
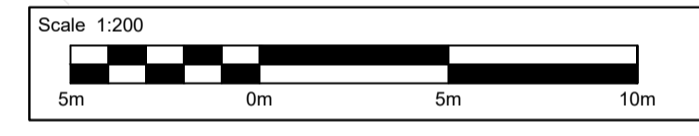

ELEVATION SCALE 1:200

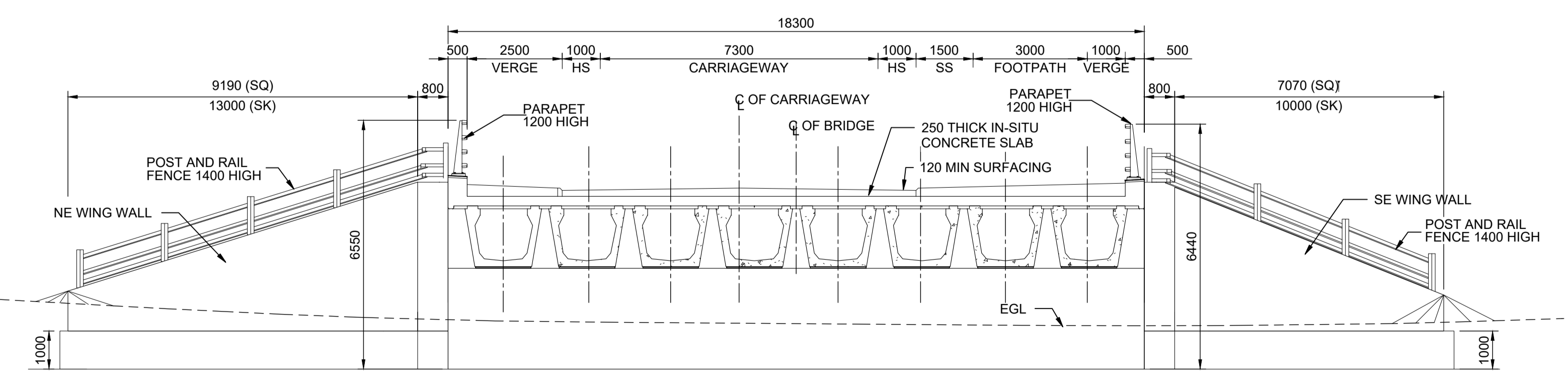
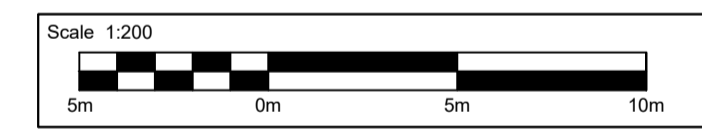

SECTION SCALE 1:100

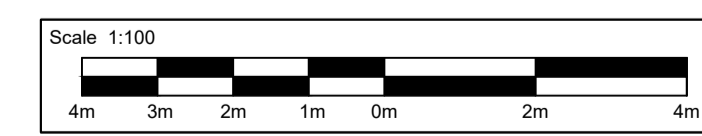

- NOTE:**
- ALL DIMENSIONS ARE IN MILLIMETRES; ALL LEVELS AND CHAINAGES ARE IN METRES UNLESS NOTED OTHERWISE.
  - FULL LENGTH OF PILES NOT SHOWN.
  - DRAINAGE NOT SHOWN
  - THESE PLANS SHOULD BE READ IN CONJUNCTION WITH SCHEDULE 1 OF THE DEVELOPMENT CONSENT ORDER (TR010034/APP/3.1).
  - THE PROPOSED WORKS WILL BE SUBJECT TO DETAILED DESIGN DEVELOPMENT. ANY CHANGES WILL BE LIMITED TO BEING WITHIN THE DCO BOUNDARY OR THE RELEVANT LIMITS OF DEVIATION, AND SUBJECT TO THE REQUIREMENTS OF SCHEDULE 2 OF THE DEVELOPMENT CONSENT ORDER (TR010034/APP/3.1).

- ABBREVIATIONS:**
- SQ - SQUARE
  - SK - SKEW
  - FGL - FINISH GROUND LEVEL
  - EGL - EXISTING GROUND LEVEL
  - FRL - FINISHED ROAD LEVEL
  - HS - HARD STRIP
  - CH - CHAINAGE
  - HS - HARD STRIP
  - SS - SEPARATION STRIP
  - VER - VERGE
  - NW - NORTH WEST
  - NE - NORTH EAST
  - SE - SOUTH EAST
  - SW - SOUTH WEST
  - TYP - TYPICAL
  - DIA - DIAMETER
  - m - METRES

This map is based on Ordnance Survey material with the permission of Ordnance Survey on behalf of the Controller of Her Majesty's Stationary Office. © Crown copyright. Unauthorised reproduction infringes Crown copyright and may lead to prosecution or civil proceedings. Highways England, 100030649, 2021.

Description	Status	Revision	Issue Date

Description	Status	Revision	Issue Date
DCO APPLICATION	A4	P01	14/05/21

Drawing Suitability	Status
DCO APPLICATION	A4



**Scheme Name**  
A57 LINK ROADS

**Drawing Title**  
STRUCTURE DETAILS  
RIVER ETHEROW BRIDGE  
REGULATION 5(2)(o) & 6(2)  
SHEET 5 OF 5

**PINS Ref No:** TR010034/APP/2.7

**Drawing Number**  
Scheme: HE551473 | Originator: BBA | Volume: LDC  
A57\_AL\_SCHEME | DR | ZL | 020735

**Location**  
AS SHOWN @ A1 | Original Size: A1 | Rev: P01

© Crown copyright (2019).

You may re-use this information (not including logos) free of charge in any format or medium, under the terms of the Open Government Licence. To view this licence:

visit [www.nationalarchives.gov.uk/doc/open-government-licence/](http://www.nationalarchives.gov.uk/doc/open-government-licence/)  
write to the Information Policy Team, **The National Archives, Kew, London TW9 4DU**,  
or email [psi@nationalarchives.gsi.gov.uk](mailto:psi@nationalarchives.gsi.gov.uk).

Printed on paper from well-managed forests and other controlled sources.

Registered office Bridge House, 1 Walnut Tree Close, Guildford GU1 4LZ  
Highways England Company Limited registered in England and Wales number 09346363